

STATE OF HAWAII
DEPARTMENT OF HEALTH
KA 'OIHANA OLAKINO
ALCOHOL AND DRUG ABUSE DIVISION
KAKUHIHEWA BUILDING
601 Kamokila Boulevard, Room 360
Kapolei, Hawaii 96707
PH: (808) 692-7506
FAX: (808) 692-7521

In reply, please refer to:
File: DOH/ADAD

Provider Meeting

Friday, October 6, 2023, at 9:00 am, via Zoom
Department of Health
Alcohol and Drug Abuse Division

AGENDA

1. Presentations

- Oxford House (Presented by Jeremy Weatherspoon, CPSS)
❖ "Peer-Run, Self-Sustaining, Substance-Free Housing"
- Tobacco Prevention & Control Section, Hawai'i State Department of Health (Presented by Jill Y. Tamashiro)
❖ Hawai'i Behavioral Health & Wellness Initiative

2. Division Announcements

- Quality Assurance Improvement Office (QAIO)
❖ *Announcements*
- *Prevention Branch (PB)*
❖ *Year-end items for Year 1 and the upcoming items for Year 2*
- *Treatment and Recovery Branch (TRB)*
❖ *GPRA training*
❖ *End of the year deadlines for invoices*
❖ *Contract/Clinical Monitoring*
❖ *Updated TRB staff*

3. Provider Announcements

- *AUW*
❖ *Hawaii CARES Updates*

4. Other

Next Meeting: Friday, November 3, 2023, Presented by Treatment and Recovery Branch (TRB).

Please send November's agenda topics, questions, and updates to your directory, to the TRB secretary,
analyn.quintal@doh.hawaii.gov



ADAD Provider Meeting

October 6, 2023



JOSH GREEN, M.D.
GOVERNOR OF HAWAII
KE KIA'ĀINA O KA MOKU'ĀINA 'O HAWAII



KENNETH S. FINK, MD, MGA, MPH
DIRECTOR OF HEALTH
KA LUNA HO'ŌKELE

STATE OF HAWAII
DEPARTMENT OF HEALTH
KA 'OIHANA OLAKINO
ALCOHOL AND DRUG ABUSE DIVISION
KAKUHIHEWA BUILDING
601 Kamokila Boulevard, Room 360
Kapolei, Hawaii 96707
PH: (808) 692-7506
FAX: (808) 692-7521

In reply, please refer to:
File: DOHADAD

Provider Meeting

Friday, October 6, 2023, at 9:00 am, via Zoom
Department of Health
Alcohol and Drug Abuse Division

AGENDA

1. Presentations
 - Oxford House (Presented by Jeremy Weatherspoon, CPSS)
 - ❖ "Peer-Run, Self-Sustaining, Substance-Free Housing"
 - Tobacco Prevention & Control Section, Hawai'i State Department of Health (Presented by Jill Y. Tamashiro)
 - ❖ Hawai'i Behavioral Health & Wellness Initiative
2. Division Announcements
 - Quality Assurance Improvement Office (QAIO)
 - ❖ *Announcements*
 - *Prevention Branch (PB)*
 - ❖ *Year-end items for Year 1 and the upcoming items for Year 2*
 - *Treatment and Recovery Branch (TRB)*
 - ❖ *GPRA training*
 - ❖ *End of the year deadlines for invoices*
 - ❖ *Contract/Clinical Monitoring*
 - ❖ *Updated TRB staff*
3. Provider Announcements
 - AUW
 - ❖ *Hawaii CARES Updates*
4. Other

OXFORD HOUSE

“Peer-Run, Self-Sustaining, Substance-Free Housing”



ORIGIN

- ◆ The first Oxford House was opened in Silver Spring, MD in 1975.
- ◆ Since then, Oxford House has expanded to:
 - ◆ 3600+ Houses & 28,000+ Beds
 - ◆ 47 US States & 6 Countries
- ◆ No one ever asked to leave without cause.
- ◆ Houses available to:
 - ◆ Men & Women
 - ◆ Women & Children -- Men & Children

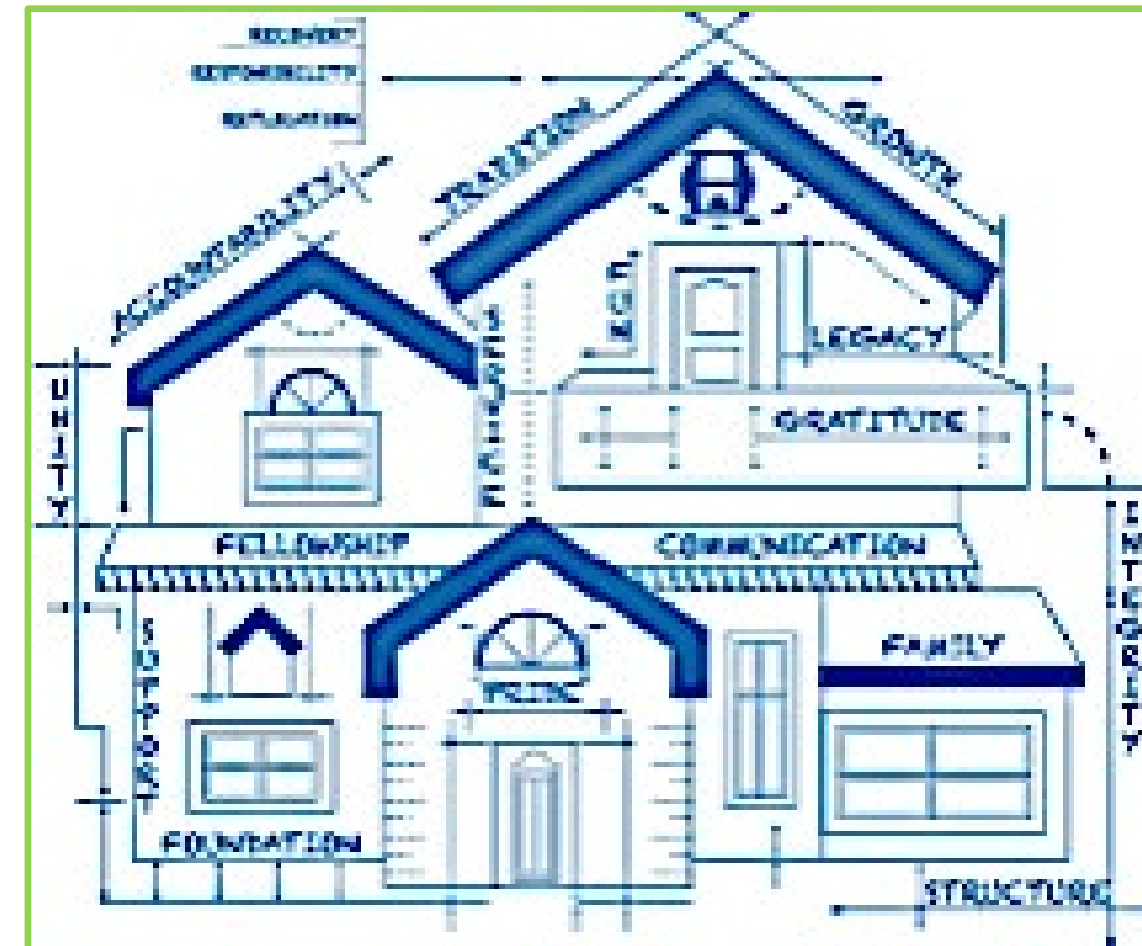



Joe Chavez, second from left, was an outreach worker in Hawaii for over 30 years until his retirement early summer of 2023. He is seen here with Paul Molloy and two residents at a June 2001 workshop.

Hawaii and Oxford House

A 32-Year Partnership

In March 1989, the federal Department of Health and Human Services published regulations to govern the administration of the state-revolving loan provisions of the 1988 Federal Anti-Drug Abuse Act. Within three months, the State of Hawaii was working with Oxford House, Inc. – the umbrella nonprofit organization for individual Oxford Houses – to help get Oxford Houses established in Hawaii. Elaine Wilson, the Division Chief of the Alcohol & Drug Abuse Division of the Department of Health, was a leader in utilizing the revolving loan provision to help groups of six or more recovering individuals establish an Oxford House.



OXFORD HOUSES IN HAWAII



Oxford House-Kaneohe Bay, Kaneohe, Hawaii
9 Men; Established Dec. 1991

One of the first Houses established in Hawaii – Oxford House- Kaneohe Bay, pictured at left – was in continuous operation from December 1991 to June 2008 when its owner passed away. This single house served hundreds of individual recovering men during the time it was open, The history of Oxford House–Kaneohe Bay is typical for an Oxford House and represents the norm for the over twenty Oxford Houses in the state.



THREE CORE PRINCIPLES

Oxford House Inc. Charter Requirements:

- Democratically ran
- Financially self-supporting
- Immediate expulsion for relapse

Also:

- Gender-specific
- Minimum of 6 adult beds
- Adherence to Oxford House Model, Traditions & Manual

Seven Steps To A Permanent Oxford House Charter Case No.

A "Conditional Charter" was provided to your House upon application and was good for an initial period of 90 days during which time your new House must demonstrate that it is fully organized and following the Oxford House system of operations. If you now have democratically elected officers, have opened a bank account in your House's name and have held at least 8 weekly business meetings, you should be ready to take that most important step to join the fellowship of Chartered Oxford Houses whose purpose is propagation and replication of the Oxford House concept by reaching out to others in the recovering community and participating actively with the National Organization in accordance with Tradition Eight of the Oxford House Manual.

Applicant House

House Name: <input type="text"/>		Date of this Application: <input type="text"/>	
Address: <input type="text"/>			
City: <input type="text"/>	State: <input type="text"/>	Zip: <input type="text"/>	Telephone: <input type="text"/>
Contact Person: <input type="text"/>	Title: <input type="text"/>	Telephone (if different): <input type="text"/>	

STEP 1. - ELECTED OFFICERS

For an Oxford House to run successfully on a democratic basis, it must have certain elected officers.
Oxford House Manual C1.

PROVIDE THE FULL NAME OF YOUR ELECTED HOUSE OFFICERS:

PRESIDENT	<input type="text"/>
TREASURER	<input type="text"/>
	<input type="text"/>
	<input type="text"/>

Oxford House, Inc.
hereby grants to
Oxford House Westhaven
Greensboro, NC
A Permanent Charter

This house may enjoy all the privileges of Oxford House as long as it adheres to the following three conditions:

1. The House must be self-run on a democratic basis;
2. The House must be financially self-supporting; and
3. Any resident who drinks alcohol or uses drugs must be immediately expelled.

Granted With the Approval of The World Council:

J. Paul M. ...
Co-founder & Chief Executive Officer
Oxford House, Inc.

April 5, 2013
DATE



HOUSES



Oxford House Mana O'lane
Honolulu, HI

- Large homes
- Nice neighborhoods
- Long-term leases
- Adequate parking
- Close to public transportation
- Close to employment
- Close to mutual-aid meetings such as 12-step meetings, out-patient treatment, and other recovery resources



VACANCY WEBSITE

Enter a location or click on a house name for directions.

State: County: Gender: Show Only Vacancies: ☐

Search: Enter a location:

House Name	Gender	City	House #	County	Contact	Contact #	Interviews	Capacity	Vacancies	Distance	Last Updated
Akone	M	Honolulu	(808) 762-7544	Honolulu	Art	(808) 342-2912	Sun 7:30am	10	1	Search by Zip	09/04/2023 3:01PM
Hau Street	M	Honolulu	(808) 762-3951	Honolulu	Ernie	(808) 226-4998	Mon 6:00pm	10	1	Search by Zip	09/04/2023 7:09PM
Heeia	M	Kaneohe	(808) 517-4790	Honolulu	Dane	(808) 318-0067	Tue 6:00pm	10	1	Search by Zip	09/04/2023 3:05PM
Ho Ohau Oli	M	Honolulu	(808) 848-8612	Honolulu	Aina	(808) 723-4446	Fri 8:00pm	7	1	Search by Zip	09/04/2023 4:05PM
Honolulu	M	Honolulu	(808) 200-1620	Honolulu	Freddy B	(808) 699-0852	Daily 4:30pm	9	0	Search by Zip	09/04/2023 7:13PM
Kalani	M	Honolulu		Honolulu	James	(808) 726-5192	Daily 7:00pm	8	0	Search by Zip	09/04/2023 6:11PM
Kalihi Valley	M	Honolulu	(808) 842-1817	Honolulu	Bronson	(808) 228-2194	Tue 7:00pm	10	0	Search by Zip	07/15/2019 3:27PM
Kalihi Women	W	Honolulu	(808) 840-3658	Honolulu	Mj	(808) 723-9061	Daily 7:00pm	8	0	Search by Zip	09/04/2023 3:19PM
Kuokoa	M	Honolulu	(808) 688-6868	Honolulu	Russel	(808) 341-4410	Tue 6:30pm	10	0	Search by Zip	07/31/2023 4:27PM
Kupale	M	Aiea		Honolulu	Brian	(808) 388-6402	Daily 1:00am	8	2	Search by Zip	09/04/2023 3:57PM



BECOMING A MEMBER

- 💧 Fill out an application (www.oxfordvacancies.com)
- 💧 Call a house to set up an interview
- 💧 Show up on time for an interview
- 💧 Be open and honest during the interview
- 💧 Acceptance = 80% yes vote by members
- 💧 If accepted, new members may move in as soon as possible.

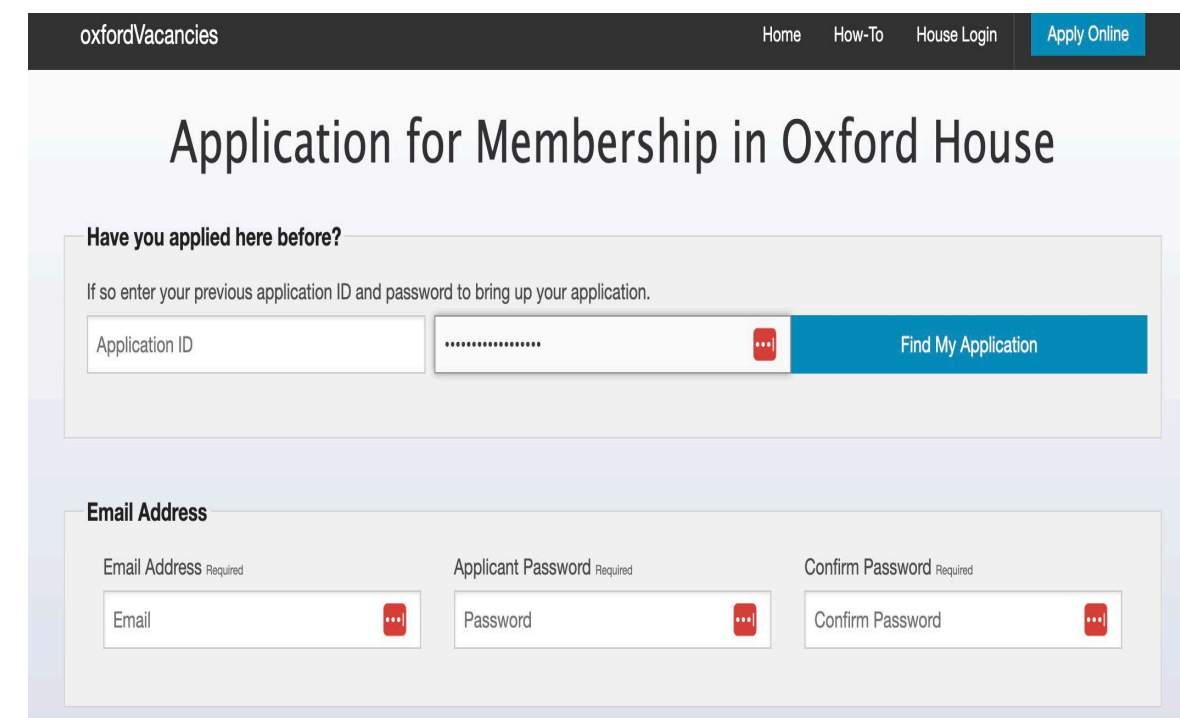

The screenshot shows the 'Application for Membership in Oxford House' form on the oxfordVacancies website. The form includes a navigation bar with links for Home, How-To, House Login, and Apply Online. The main section is titled 'Application for Membership in Oxford House'. It asks 'Have you applied here before?' and provides a field for 'Application ID' and a password field to 'Find My Application'. Below this, there is a section for 'Email Address' with fields for 'Email', 'Applicant Password', and 'Confirm Password', each marked as 'Required'.



STRUCTURE

- Over 47 years of experience in what works
- Three core charter requirements
- Nine traditions
- House Manual
- Chapter Support
- State Association Support
- Alumni Support
- Outreach Support (Technical Assistance)
- Oxford House, Inc. Support

Key Manuals To Keep Oxford House On Track

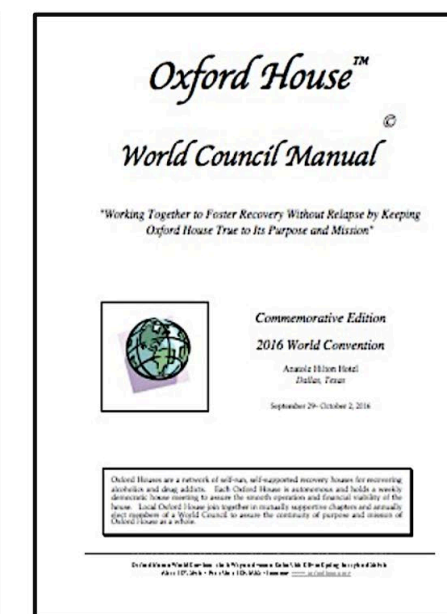
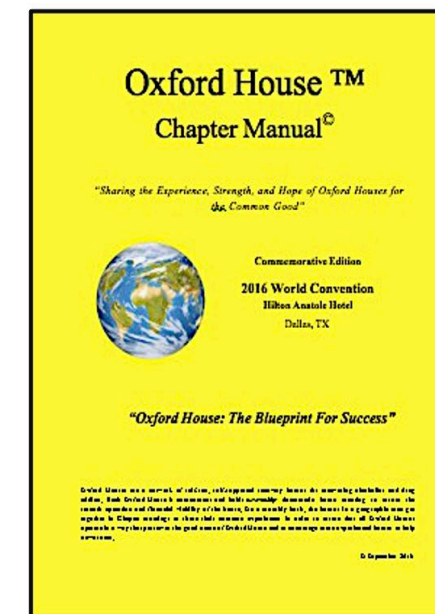
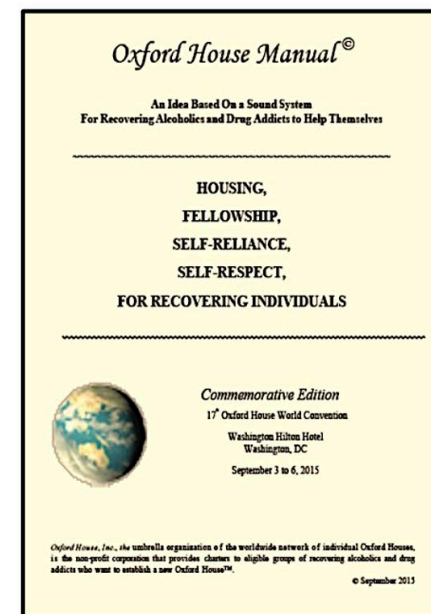

STRUCTURE

House Meeting

- Weekly
- Parliamentary Procedure
- Democracy in action
- Financial decisions
- Contracts
- Majority Rules
- How goes it

House Officers: (six-month terms)

- President
- Secretary
- Treasurer
- Comptroller
- Chore Coordinator
- Housing Services Rep.



STRUCTURE

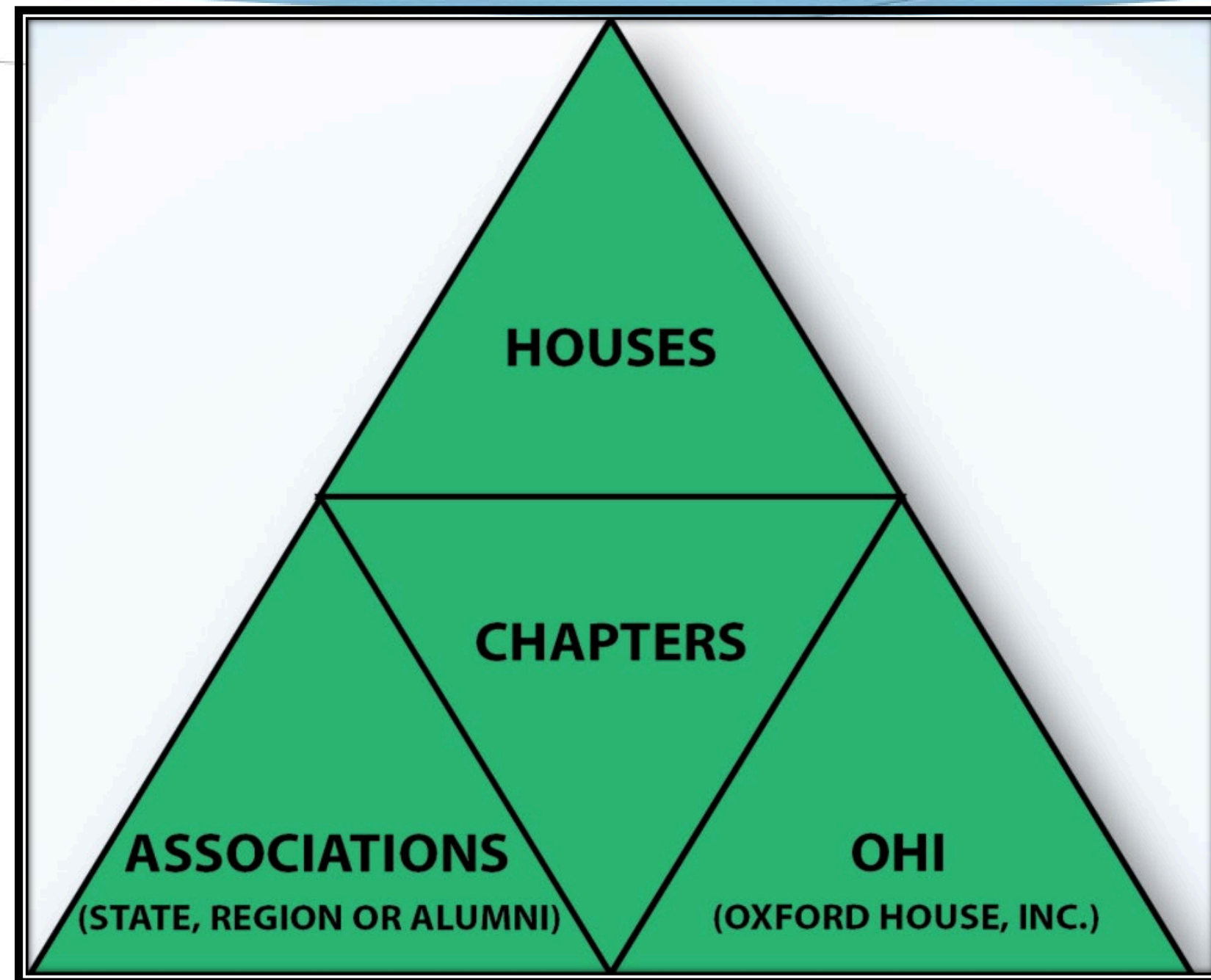

OUTREACH SUPPORT (TECHNICAL ASSISTANCE)

Oxford Houses

- ◆ Loan Application Assistance and Approval
- ◆ Finding a Suitable House to Rent
- ◆ Lease Negotiation
- ◆ Bank Account and Obtaining FEIN
- ◆ Physical Set-up – beds, dressers and more
- ◆ Updating and Maintaining ADAD's Clean and Sober Registry

Oxford House Members

- ◆ Operational System Training
- ◆ Volunteer Coordination
- ◆ Leadership Development
- ◆ Systems Implementation
- ◆ Serving as Institutional Memory



OUTREACH SUPPORT (NETWORKING)

- 💧 Traveling to communities throughout the country and abroad in need of the Oxford House model as a resource.
- 💧 Engaging with local community members, organizations, and agencies.
- 💧 Establishing new Oxford Houses as part of a community effort.
- 💧 Presentations and more presentations.
- 💧 Connecting Oxford Houses to Support Networks.
- 💧 Building Community Partnerships with Local Organizations to provide access to other recovery resources.



Beyond Housing: Comprehensive Member Support

Overview of networking opportunities and resources offered:

- ◆ Access to HiSet and Higher Education opportunities
- ◆ Links to Mental Health Treatment/Therapy
- ◆ Acceptance of residents on MAT/MAR and education on the use of Narcan
- ◆ Support in applying for SNAP/Medicaid benefits
- ◆ Participation in Job & Resource Fairs to offer additional employment opportunities to residents
- ◆ Community Integration: Engaging members in community events, volunteering, and fostering a sense of belonging.
- ◆ Building Community Partnerships with Local Organizations to provide access to other recovery resources.



The Oxford House Model: Beyond Housing



Residents at Oxford House – Puali House Meeting

Oxford House Basics:

- Focus: Safe, drug-free environment for recovery.
- Inherent Benefits: Life skills development, self-efficacy & employment support.

◆ How Oxford House Promotes Life Skills Development

- ◆ Self-governance
- ◆ Financial Responsibility
- ◆ Accountability
- ◆ Rebuilding Lives
- ◆ Networking and Community





Picture Of Hawaii Oxford House
Residents And Alumni At The 2018
Convention In Kansas City

Self-Governance

Residents are in charge - promoting communication, problem-solving, and leadership skills.

Financial Responsibility

Residents contribute to shared expenses, fostering financial planning & budgeting.

Accountability & Rebuilding Lives

Self-governed guidelines encourage discipline vital for work, and a supportive environment pushes towards self-improvement.





The original Oxford House Hawaii logo above was designed by residents of the houses circa 1996.

Networking & Community

Interaction with other Oxford Houses offers valuable networking for job leads and resources.

Oxford House Outreach Staff

Outreach staff understand community challenges & strengths, linking residents with job opportunities and skills workshops.

Workshops & Education

Oxford House staff offer workshops on all the positions in the Oxford House Model, giving residents experience in writing, interviewing, finance, etc.

Residents are encouraged to pursue education & vocational training.



OVERALL BENEFITS

Proven Success

How Do We Know...

Recovery housing can be a critical asset in supporting an individual on their journey of recovery. Research has demonstrated that recovery housing is associated with a variety of positive outcomes for residents. Several studies highlight this, including Jason et al. 2006; Jason & Ferrari, 2010; Polcin et al., 2010.

Outcomes included decreased substance use, reduced likelihood of return to use, lower rates of incarceration, higher income, increased employment, and improved family relationships.

Members Receive:

- ◆ Peer support
- ◆ Accountability
- ◆ Responsibility
- ◆ Safety
- ◆ Stability
- ◆ Greater chance of success
- ◆ Self Efficacy



CONTACT INFO:

Jeremy J Weatherspoon, CPSS (Regional Manager)
jeremy.weatherspoon@oxfordhouse.org
(602) 625-0960

Nalu Dias (Outreach Worker)
nalu.dias@oxfordhouse.org
(808) 489-3012

Oxford House, Inc.
info@oxfordhouse.org



Hawai'i Behavioral Health & Wellness Initiative

In-person gathering
November 20, 2023
Queen's Conference Center
Plan for all day

Meeting topic: Addressing tobacco use among those with substance use disorders (SUD) using a wellness approach

- **Purpose:**

- Understand the importance of addressing tobacco use among those with SUD
- Learn about a successful model used in California & a Hawai'i pilot project
- Network & share challenges & best practices with colleagues

Adult current cigarette smoking in Hawai'i, BRFSS 2021

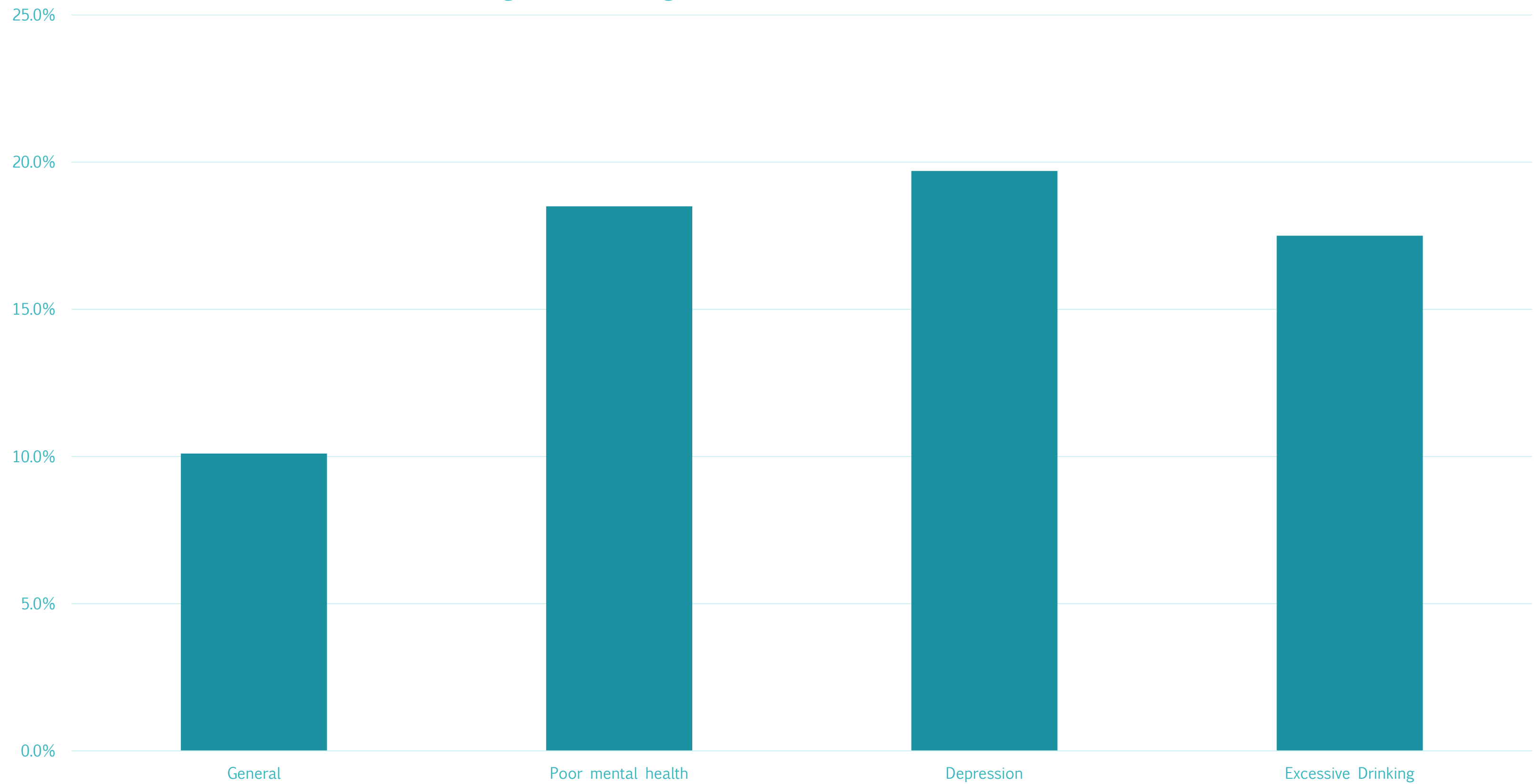

Current Smoking Among Adults (age> 18) With Past Year Behavioral Health (BH) Condition: NSDUH, 2008-2020

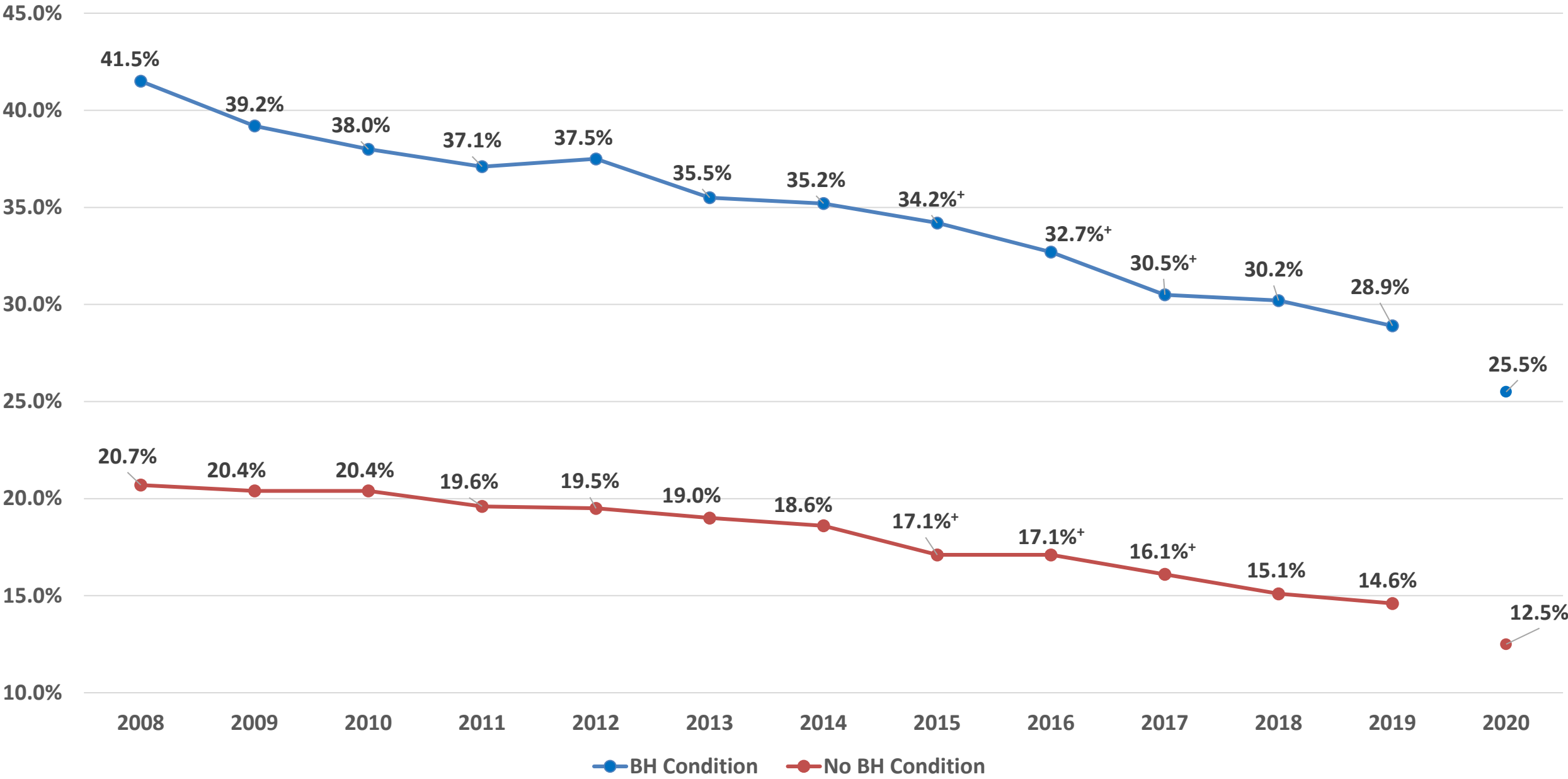

Adults with mental health or substance use disorders represent **25%** of the population, but account for **40%** of all cigarettes smoked by U.S. adults

Behavioral Health Condition includes AMI and/or SUD. Due to changes in survey questions regarding substance use disorders in 2015, including new questions on meth and prescription drug misuse, this data is not comparable to prior years. *Difference between this estimate and the 2018 estimate is statistically significant at the .05 level **SUD-related questions were adjusted in 2015.
Note: Substance use disorder (SUD) estimates in 2020 are based on criteria from the Diagnostic and Statistical Manual of Mental Disorders, 5th edition (DSM-5). There is no connecting line between 2019 and 2020 to indicate SUD and related estimates are not comparable between 2020 and prior years of NSDUH, because prior years' estimates were based on DSM-IV criteria. Due to these changes, significance testing between 2020 and prior years was not performed.

Hawai'i Adults Who Currently Smoke Cigarettes by Mental Illness Status, NSDUH 2019-2020

- 17.9% AMI
- 22.6% AMI + cigarettes
- 15.6% No AMI + cigarettes

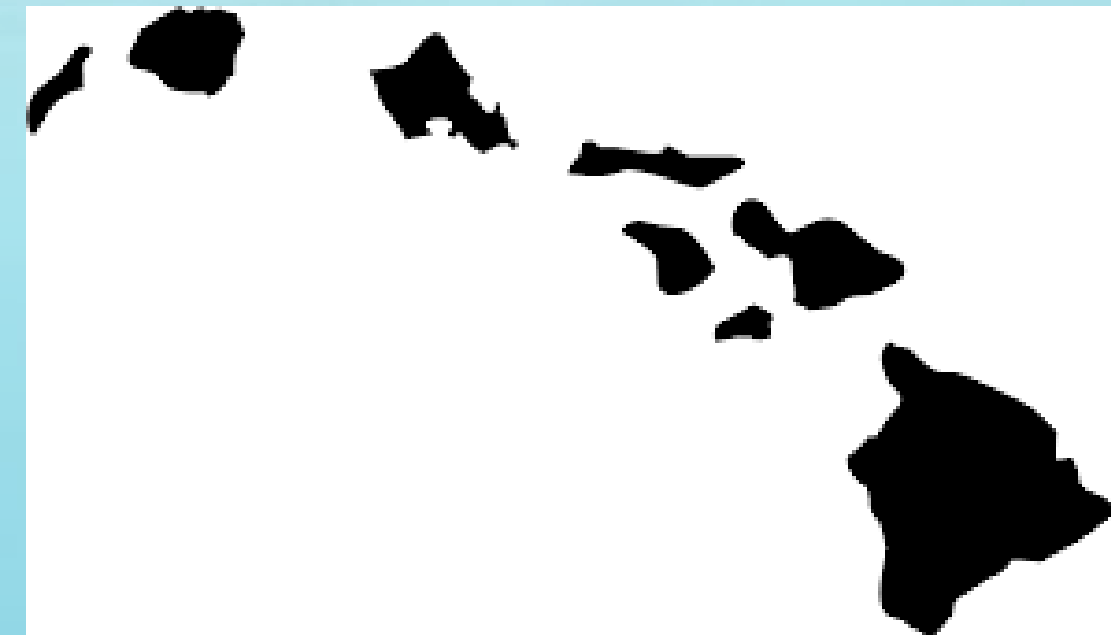

Save the Date & Spread the word!

- Hawai'i Behavioral Health & Wellness Initiative
- November 20, 2023, Monday
- In-person, all day
- Queen's Conference Center (Queen's Medical Center)
- Honolulu, HI
- TBD: CEU & travel scholarships
- **Who should attend?** Substance use treatment staff & administrators, community partners interested in this project

For More Information

- Jill Tamashiro
- Chronic Disease Prevention & Health Promotion Division, Tobacco Prevention & Control Section (TPC)
- jill.tamashiro@doh.hawaii.gov

Division Announcements



Prevention Branch (PB)



- End of Contract Year 1 Reminders
 - Quarter 4 Report due Oct. 15
 - Final Invoice due Oct. 15
 - Year-end Report due Oct. 30
 - Final Evaluation Report due Oct. 30



Prevention Branch (PB)



- FY 24 Contract Reminders
 - Please review FY24 Timeline of deliverables located on the ADAD website.
 - FY24 Evaluation Agreements due Oct. 31
 - If applicable, update WITS Plan by Nov. 3
 - NEW FY24 BU & MSF (Forms) will be sent out by November, to complete October invoices.

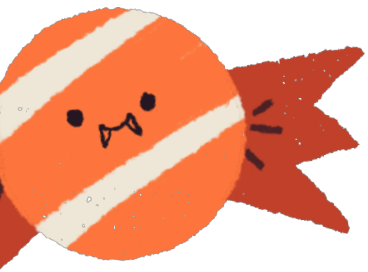
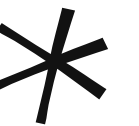

* Treatment and Recovery Branch (TRB) *

- GPRA training
- End of the year deadlines for invoices
- Contract/Clinical Monitoring
- Updated TRB staff





Provider Announcements



Hawaii CARES Update

ALOHA UNITED WAY - HAWAII CARES

SUD SEASONAL DATA 2022/2023

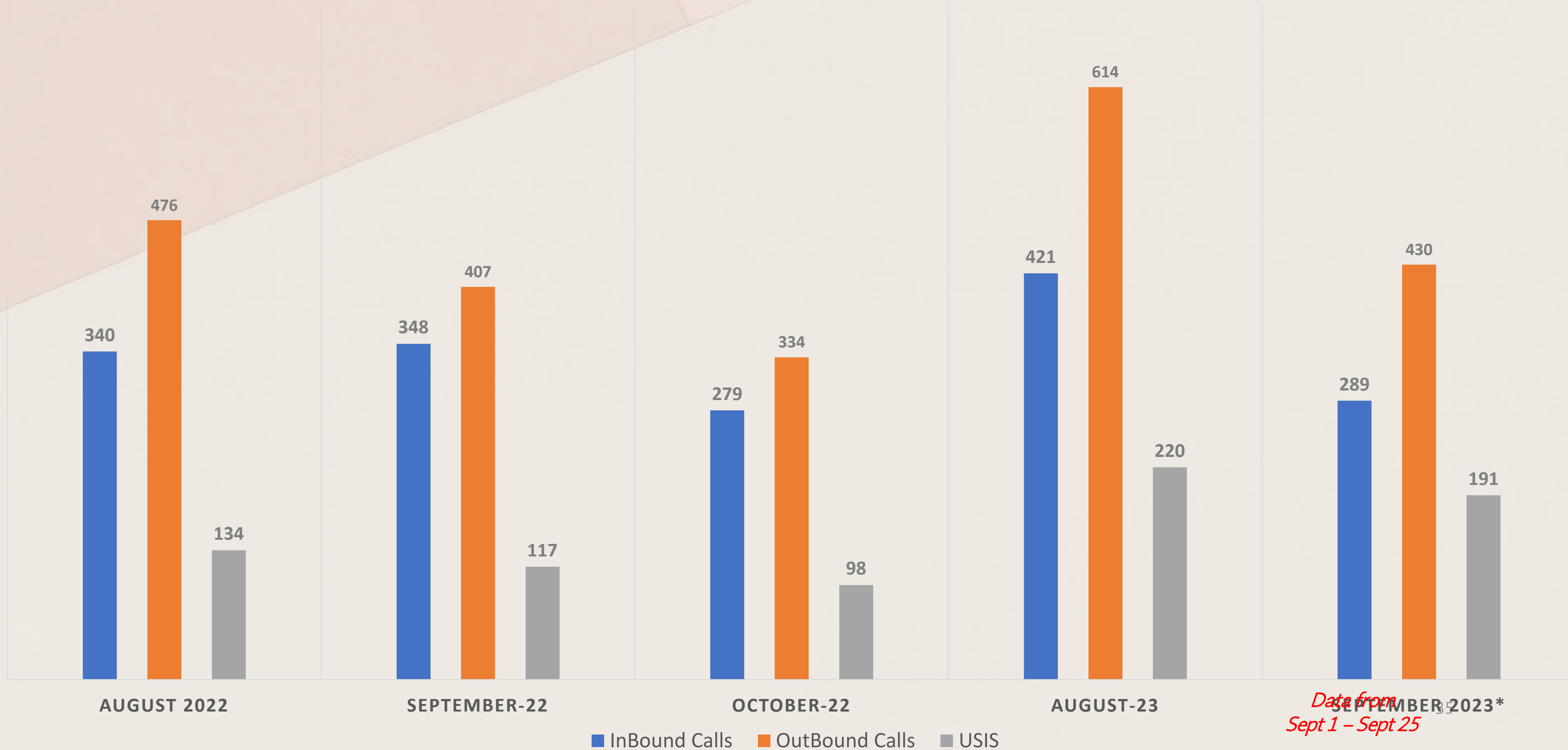

ALOHA UNITED WAY - HAWAII CARES

SUD SEASONAL REFERRAL DATA 2022/2023

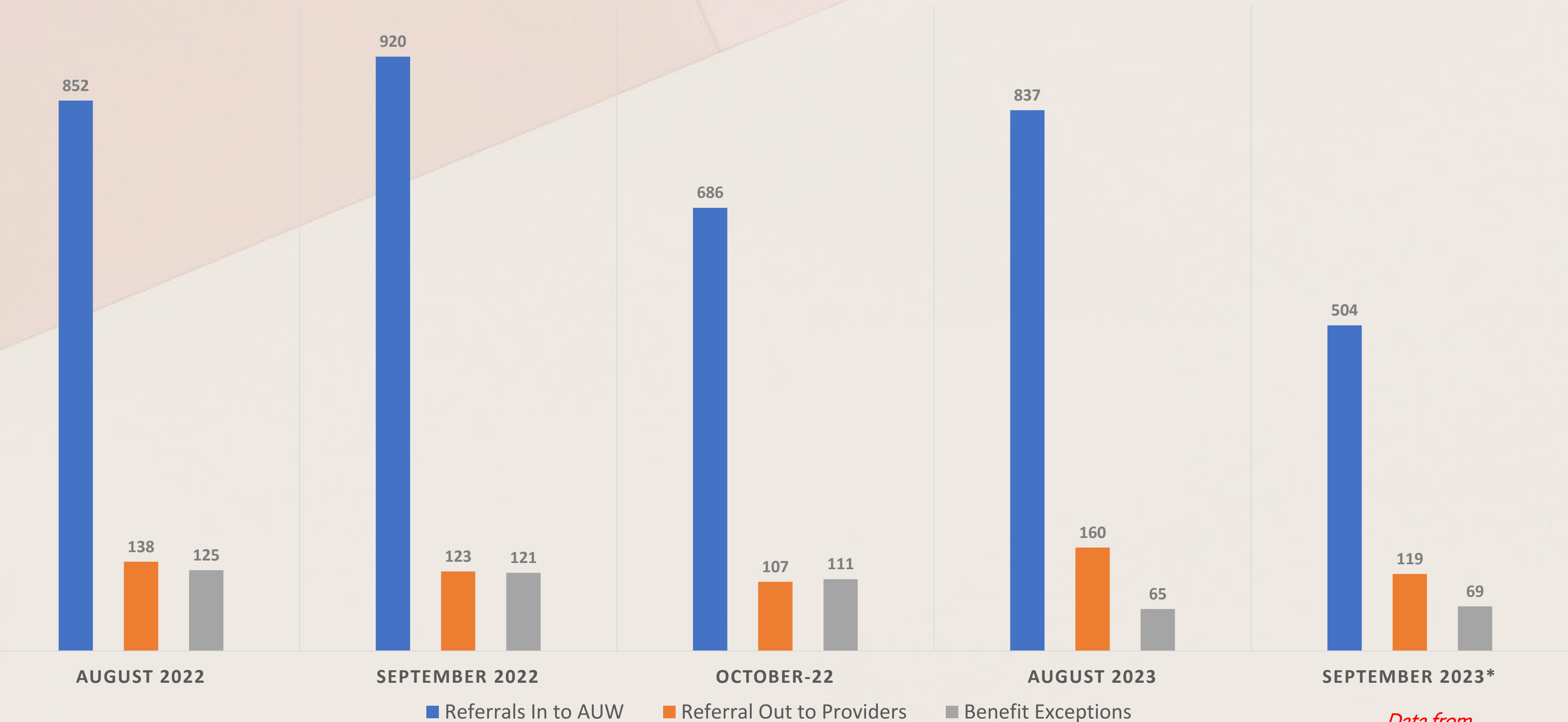

*Data from
Sept 1 – Sept 25³⁶*

ALOHA UNITED WAY - HAWAII CARES

Referrals Placed/Accepted from Providers to AUW (Sept 2023)

[Back to report](#)

REFERRALS IN - PLACED/ACCEPTED

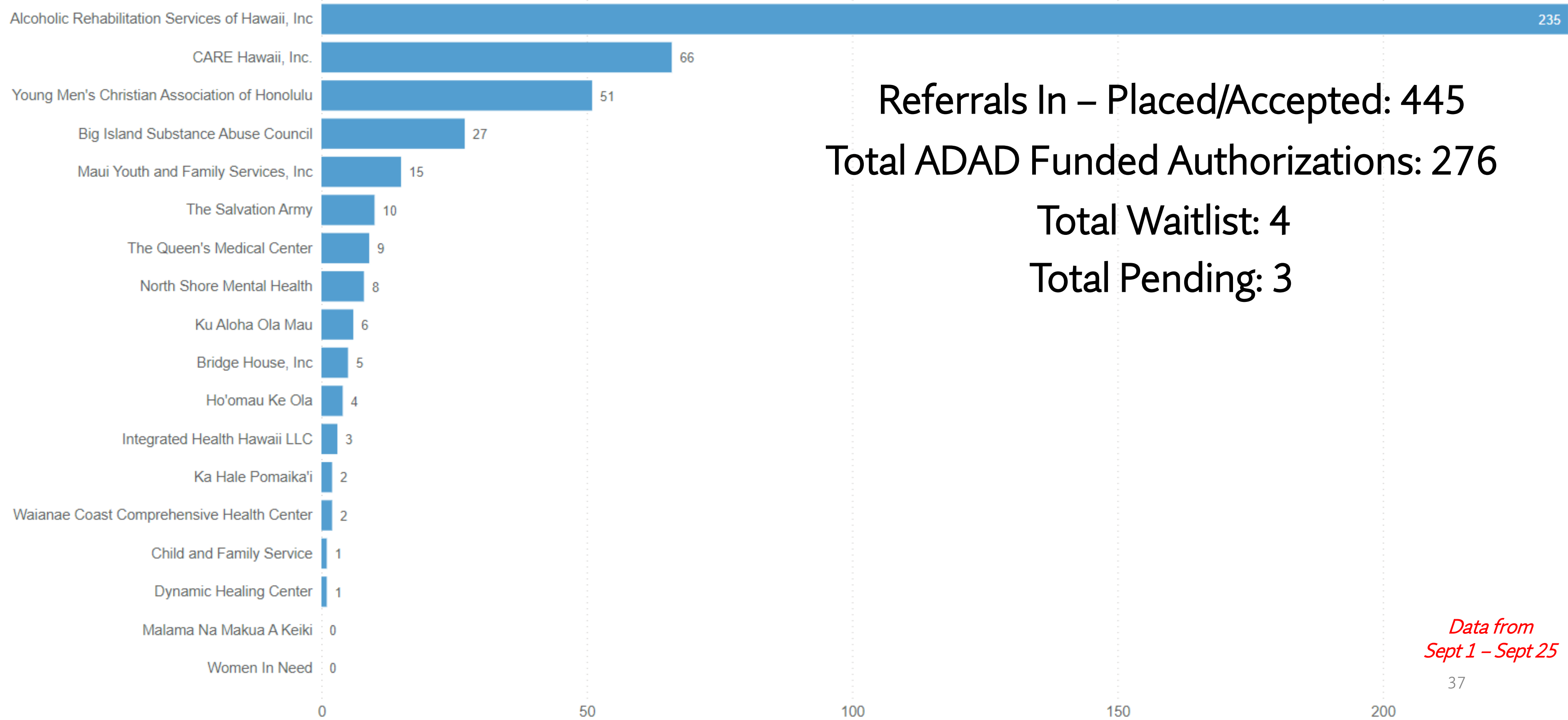

Referrals In – Placed/Accepted: 445
Total ADAD Funded Authorizations: 276
Total Waitlist: 4
Total Pending: 3

*Data from
Sept 1 – Sept 25*

ALOHA UNITED WAY - HAWAII CARES

SUD Referrals Out to Providers (September 2023)

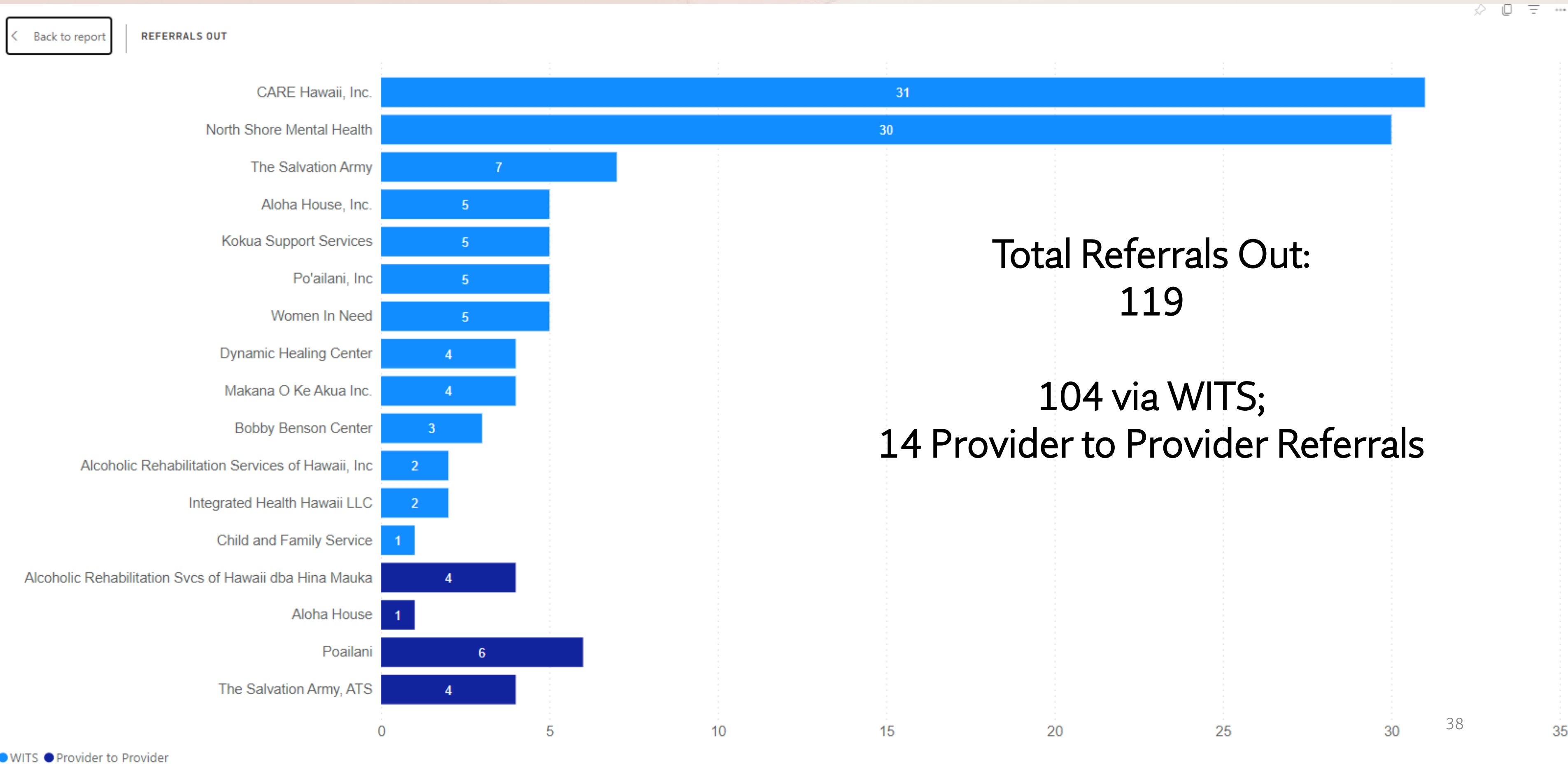

Thank You!



Next Meeting:
Friday, November 3, 2023
Presented by TRB



Please send November's agenda topics, questions, and updates to your directory to the TRB Secretary,

analyn.quintal@doh.hawaii.gov

