

# PARKING COMMITTEE 05/18/26

## LIST OF BOARD PACKET DOCUMENTS

1. Parking Committee Agenda for 05/18/26.
2. Parking Committee Draft Minutes for 3/31/26.
3. Draft Survey of Disability Parking Permittees.
4. Fiscal Year 2026-2027 Draft Plan of Action.
5. Article “- [A Malpractice Case Against ParkingMD - New Mobility](#) - A new website promising to make getting disabled parking permits “fast & easy” threatens to destroy an already flawed system.”
6. Facebook Advertisements and email solicitations from ParkingMD.
7. Parking Permit Database Report for Fiscal Year 2025-2026 Q3
8. Parking Unit Report (parking permit issuance statistics, email notifications to permittees, procurement of supplies, death retrieval process, webpage for reporting placard or access aisle abuse, webpage for reporting non-design compliant accessible parking spaces) for Fiscal Year 2025-2026 Q2.
9. Graph – Renewal of long term placards for April year to year comparison.
10. State of Illinois accessible parking pamphlet: “[Guide for Medical Professionals](#)”
11. State of Arkansas Pamphlet – Parking Etiquette.



# DISABILITY AND COMMUNICATION ACCESS BOARD

Ka 'Oihana Ho'oka'a'ike no ka Po'e Kīnānā

1010 Richards Street, Rm. 118 • Honolulu, Hawai'i 96813  
Ph. (808) 586-8121 (V) • Fax (808) 586-8129 • (808) 204-2466 (VP)

## NOTICE OF MEETING

Disability and Communication Access Board  
Standing Committee on Parking  
May 18, 2026  
12:00 p.m.

The public is welcome to participate as follows:

### **Physical Meeting Location**

Kamamalu Building  
1010 Richards Street, Room 111A and 111B  
Honolulu, HI 96813

### **Participate Virtually via Zoom**

Click on the link below or copy and paste it into your browser window:  
<https://us02web.zoom.us/j/86243295951> and enter Meeting ID: 862 4329 5951

### **To join by phone**

Dial 1 669 444 9171 and enter Meeting ID: 862 4329 5951

One tap mobile: +16694449171,,86243295951# US

### **HOW TO TESTIFY:**

**Written testimony** – There is no deadline for submission of testimony, however, to ensure the public as well as Committee members are able to review testimony prior to the meeting, we request written testimony be submitted no later than 9:00 a.m. one business day prior to the scheduled meeting date and time.

- **To Submit by Email:** Email the Standing Committee on Parking at [dcab@doh.hawaii.gov](mailto:dcab@doh.hawaii.gov). Please include TESTIMONY in the subject line.

- **To Submit by U.S. Postal Mail or Hand-Delivery:**

Attention: Standing Committee on Parking – Testimony  
Disability and Communication Access Board  
1010 Richards Street, Room 118  
Honolulu, Hawaii, 96813

- **To Submit via facsimile:** (808) 586-8129.

**Oral testimony** will be accepted via the remote testimony link or in-person at 1010 Richards Street, Room 111A and 111B, Honolulu, Hawaii, 96813.

Testimony or comments presented by members of the public during the Committee meetings shall be limited to three minutes per agenda item. In compliance with the Americans with Disabilities Act (ADA), a reasonable amount of additional time shall be afforded to persons with a communication disability to present testimony or comments, if needed. Any person who needs additional time to present testimony or comments is encouraged to contact the DCAB office in advance of the meeting. This rule shall be placed at the beginning of all Committee meeting agendas.

Members of the public may present comment or testimony during Committee meetings on each agenda item. Public comment or testimony, if any, shall be presented on each agenda item before the Committee deliberates on the item. After all public comment or testimony is presented, the Committee shall deliberate on the agenda item without further comment or testimony from the public unless further public comment or testimony is requested by the Committee.

## **AGENDA**

### I. Call to Order

#### Review Remote Meeting Procedures

- This meeting is being recorded.
- A quorum of Committee members is required to be visible on screen.
- If quorum is not achieved at the beginning of the meeting, the meeting will be cancelled within fifteen (15) minutes after the scheduled start time and update any posted notices or calendar accordingly.
- If a Committee member leaves the meeting permanently at any time, the Committee member shall notify the Chairperson. If this results in a lack of quorum, the meeting will adjourn at that time.
- If a Committee member leaves the meeting temporarily, the Committee member shall notify the Chairperson. If this results in a lack of quorum, the Chair shall call a recess. If the Committee member does not return within ten (10) minutes, the meeting will be adjourned.
- Raise hand to speak unless called upon.
- Identify yourself before speaking however public testifiers may use an alias to maintain anonymity.

### II. Roll Call/Introductions

### III. Public Testimonies Submitted – Review

### IV. Approval of Meeting Minutes for March 31, 2026.

### V. Old Business

- #### A. Proposed Draft Survey to Disability Parking Permittees.

B. Updates on Death Records Crossmatch and Disability Parking Permit Retrieval.

C. Updates on State Legislation

[House Bill 469 House Draft 2 Senate Draft 2](#) – Relating to Parking for Disabled Persons. Requires the Disability and Communication Access Board to issue a disability travel placard to an applicant who has a valid removeable windshield placard or disabled paid parking exemption permit but does not have a valid special license plate, and provides proof of travel.

Link to the House Bill 469 House Draft 2 Senate Draft 2:

[https://www.capitol.hawaii.gov/session/measure\\_indiv.aspx?billtype=HB&billnumber=469&year=2026](https://www.capitol.hawaii.gov/session/measure_indiv.aspx?billtype=HB&billnumber=469&year=2026)

(a) Administrative Rules Amendment Process.

(b) Travel Placard Statistics for the State of Oregon and projections for the State of Hawaii travel placard.

D. County of Hawaii – [Bill 132](#) – An Ordinance Amending Chapter 6 of the Hawaii County Code 1983 (2016 Edition, as Amended) by Adding an Article Relating to Paid Parking Facilities in Kailua Village. This bill would require paid parking facilities in Kailua Village to have accessible parking spaces that comply with the Americans with Disabilities Act Standards for Accessible Design.

Link to the County of Hawaii Bill 132:

<https://records.hawaiicounty.gov/weblink/DocView.aspx?dbid=0&id=1125213&page=1&cr=1>

## VI. New Business

A. Review of Fiscal Year 2026-2027 Draft Plan of Action.

B. Review of Article “- [A Malpractice Case Against ParkingMD - New Mobility](#) - A new website promising to make getting disabled parking permits “fast & easy” threatens to destroy an already flawed system.”

Link to the article: <https://newmobility.com/a-malpractice-case-against-parkingmd/>

C. Death Records Crossmatch and Disability Parking Permit Retrieval (June 2026).

D. Disability Parking Placard Issuance Statistics for Quarter 3 Fiscal Year 2025-2026.

- E. Email Notification to Permittees of Pending Parking Permit Expirations for Quarter 3 Fiscal Year 2025-2026.
  - F. Procurement of Disability Parking Placards and Month/Year Decals.
  - G. Webpage for Reporting Placard or Access Aisle Abuse - Quarter 3 Fiscal Year 2025-2026 Number of Submissions.
  - H. Webpage for Reporting Non-Design Compliant Accessible Spaces - Quarter 3 Fiscal Year 2025-2026 Number of Submissions.
  - I. Review of State of Illinois accessible parking pamphlet: "[Guide for Medical Professionals](#)" and discussion if DCAB should develop one for Hawaii.  
  
Link to the State of Illinois accessible parking pamphlet:  
<https://accessibleparkingcoalition.org/wp-content/uploads/vsd688.pdf>
  - J. Review of Arkansas law restricting the use of van accessible spaces for permittees who use certain mobility aid devices.
- VII. Open Forum: Public comment on issues not on the agenda for consideration for the Committee's agenda at the next meeting.
- VIII. Next Meeting
- IX. Adjournment

**HOW TO REQUEST ACCOMMODATION:**

If you need an auxiliary aid/service or other accommodation due to disability, contact Cindy Omura or Scott Castor at (808) 586-8121 or [dcab@doh.hawaii.gov](mailto:dcab@doh.hawaii.gov) as soon as possible. Requests made as early as possible have a greater likelihood of being fulfilled.

Upon request, this notice is available in alternate/accessible formats.

**MEETING MATERIALS AND OTHER INFORMATION:**

The agenda and meeting materials for this meeting are available for inspection at DCAB's office located at 1010 Richards Street, Room 118, Honolulu, Hawaii 96813 and on DCAB's website at: <https://health.hawaii.gov/dcab/dcab-agendas-and-minutes/>.

If the remote connection (via Zoom) is lost, the meeting will be recessed for up to thirty (30) minutes to restore communication. If the connection is lost, we will attempt to restart the meeting again with the same link. If the Committee is unable to reconvene the meeting because neither audiovisual communication nor audio communication can be reestablished within thirty minutes, the meeting will be automatically terminated.

If you have trouble entering the meeting, please contact Cindy Omura or Scott Castor at (808) 586-8121.



# DISABILITY AND COMMUNICATION ACCESS BOARD

Ka 'Oihana Ho'oka'a'ike no ka Po'e Kīnānā

---

1010 Richards Street, Rm. 118 • Honolulu, Hawai'i 96813  
Ph. (808) 586-8121 (V) • Fax (808) 586-8129 • (808) 204-2466 (VP)

## **DRAFT MINUTES** **Standing Committee on Parking Meeting**

Location: Virtual via Zoom and 1010 Richards Street Room 118  
Date: March 31, 2026  
Time: 12:00 p.m.

PRESENT: Violet Horvath, Chairperson; Gerald Ohta, Charlotte Townsend, Board Members; Bryan Mick, Kristine Pagano, Mylynne Simon, Staff

ABSENT: Dayne Greene, Board Member

### SIGN LANGUAGE

INTERPRETER: Jenny Blake

- I. Chairperson Violet Horvath called the meeting to order at 12:09 p.m.
- II. Committee members and staff introduced themselves.
- III. Public Testimonies Submitted – Review
  - A. No public testimonies were submitted.
- IV. The Committee approved the January 23, 2026, meeting minutes as circulated (M/S/P Townsend/Ohta).
- V. Old Business
  - A. Proposal of a Draft Survey to Disability Parking Permittees.

The following changes were made to the Draft Survey to Disability Parking Permittees:

- Question 6 – “Can you safely enter or exit your vehicle if you park in a standard accessible parking space (has a 5 foot wide access aisle)?”
- Added “Typically” to the beginning of the question.

Question 7 – “Which of the following features of an accessible parking space do you require use of? (check all that apply)”.

- Changed question to “How often do you require extra space on both sides of your vehicle so when BOTH the driver and passenger(s) with disabilities are all able to safely exit the vehicle?”
- Changed answer options to “Always”, “Sometimes”, “Rarely”, “Never”.

Question 9 – “On a scale from 1 to 5 with 1 being very often and 5 being never, please rate how often you are unable to park in an accessible parking space because the access aisle is not located on the side you or your passenger exits the vehicle from?”

- Chairperson Violet Horvath suggested that for this and future questions that the permittee chooses an option from 1 to 5, the survey lists the quality the number represents. For example, 1 representing “Always” and 5 representing “Never”.

New question to be added between Question 10 and Question 11 – “How often have you had to use 2 conventional parking spaces to create an accessible access aisle when no accessible spaces are available?”

- Added options “Always”, “Sometimes”, “Rarely”, “Never”.

Question 11 – “On a scale from 1 to 5 with 1 being easy and 5 being hard, please rate the difficulty of finding an available accessible parking space for the locations below:”

- Chairperson Violet Horvath suggested that a table be created with checkboxes so that it is easier for the permittee to choose an answer correlating to each location.
- Changed “shopping malls” to “shopping centers”.

Question 12 – “Which type of areas do you usually park or attempt to park in an accessible space? (check all that apply)”

- Changed “shopping malls” to “shopping centers”.

Question 13 – “On a scale from 1 to 5 with 1 being often and 5 being never, please rate the frequency of the following scenarios at locations you attempt to visit.”

- Added option “connection of accessible parking spaces to accessible route are not considered/compliant.”

Question 14 – “Which of these conditions have you noticed at the locations you visit? (check all that apply):”

- Removed “/lack of an accessible path to facility” from option “No curb cut and ramp near the accessible parking spaces”.

Question 16 – “Have you been unable to pay for parking in an off street parking lot due to the method of payment?”

- Changed question to “Have you ever been unable to pay for parking in an off street parking lot due to a payment barrier?”
- Changed option “Yes, cash only” to “Yes, only accepted cash”
- Changed option “Yes, credit or debit card only” to “Yes, only accepted credit or debit card”
- Changed option “Yes, QR code only” to “Yes, payment by QR code only”
- Added option “Yes, equipment was unreachable”
- Added option “Yes, I could not see or read the payment display”

B. Updates on Death Records Crossmatch and Disability Parking Permit Retrieval.

A crosscheck with Vital Record flagged three thousand four hundred (3,400) records and letters were sent starting January 2, 2026. As of March 24, 2026 forty five percent (45%) were returned, four percent (4%) were reported as lost, and twelve (12%) of the letters were undeliverable.

C. Discussion of Concerns with Parking Lots Only Accepting Payment via QR Code.

[Senate Bill 3255 Senate Draft 1](#) - Relating to Currency. Requires retail merchants to accept cash payments in in-person transactions. Requires cash transactions to be rounded up or down to the nearest five cents. Requires cash transactions that total \$0.01 or \$0.02 to be rounded up to \$0.05. Exempts transactions in which payment is made by demand or negotiable instrument, electronic fund transfer, check, gift card, money order, credit card, or other like instrument or method. Effective 7/1/2050.

The most recent draft of this bill eliminated the sentence “Requires retail merchants to accept cash payments in in-person transactions”.

Bryan Mick suggested that in the interim until next legislative session, a cash must be accepted bill could be drafted to have a narrower focus on applying to parking, medical facilities, and food and beverage retail; or it could be more general but include certain exceptions.

D. Updates on State Legislation

1. Senate Bill 2366 failed to pass this legislative session and will be revisited next legislative session.
2. House Bill 2375 House Draft 2 has been turned into a working group that

included DCAB. If this bill passes, DCAB staff will work with the group to ensure that accessible parking is not negatively impacted.

3. House Bill 2442 House Draft 2 failed to pass this legislative session and will be revisited next legislative session. During the interim between legislative sessions, DCAB staff will reach out to relevant entities to see if there are ways to address concerns they may have.

## VI. New Business

### A. County of Hawaii – Bill 132

DCAB testified in support of this bill as it would amend county ordinances to include requirements for the design of accessible parking spaces.

### B. Disability Parking Placard Issuance Statistics for Quarter 3 Fiscal Year 2025-2026

In the third quarter of FY 2025-2026 through March 24, 2026 around seven thousand two hundred (7,200) placards were issued and three hundred sixty eight (368) special license plates reauthorized or issued. Of the placards, about one thousand nine hundred (1,900) were temporary, five thousand three hundred (5,300) long term, and eight (8) were Disabled Paid Parking Exemption Permits. Of the long term placards, about two thousand three hundred (2,300) were renewals issued by DCAB. The renewal rate was sixty five percent (65%).

### C. Review of Article – Disabled Florida woman sues state over new pregnancy parking law

DCAB staff occasionally get calls from pregnant people asking if they are eligible for the disability parking permit. Bryan Mick stated that DCAB would be generally opposed to expanding the eligibility criteria due to the current shortage of accessible parking spaces.

## VII. Next Meeting

The next Parking Committee meeting will take place on May 18, 2026, at 12:00 p.m.

## VIII. Adjournment

The meeting adjourned at 1:06 p.m.

NOTE: All votes were unanimous unless otherwise noted.

Respectfully submitted,

MYLYNNE N. SIMON

Aloha Disability Parking Permit Holder,

The Disability and Communication Access Board (DCAB) wants to know what problems you encounter when trying to park in an accessible parking space. The data collected from this survey will help guide future recommendations to improve the parking program. We ask that you take five minutes to answer eighteen questions in our survey. All responses are anonymous and no personal identifying information is requested. If you are filling out the survey on behalf of someone else, please answer from their point of view. Please submit only one survey. If you have any questions or concerns, please contact DCAB by phone at (808) 586-8121 or by email at [dcab@doh.hawaii.gov](mailto:dcab@doh.hawaii.gov).

1. My age bracket is:  0 to 20       21-40       41-60       61 to 80       81 or older

2. What kind of disability parking permit do you have? (Please select one option)

Temporary Placard (red).

Long term placard (blue).

Disabled Paid Parking Exemption Permit (green).

Special License plate only.

Special license plate and long term placard (blue).

Special license plate and disabled paid parking exemption permit (green).

3. Which County do you live in?

City and County of Honolulu

County of Hawaii

County of Maui

County of Kauai

None of the above

4. Which of these describe you?

Always the driver.

Always the passenger.

Usually a driver, occasionally a passenger.

Usually a passenger, occasionally a driver.

5. Which one of these describes the private vehicle you primarily ride in or drive?

- No mobility ramp on the vehicle.
- Mobility ramp on the right (passenger) side of the vehicle.
- Mobility ramp on the left (driver) side of the vehicle.
- Mobility ramp in the rear of the vehicle.



6. Typically, can you safely enter or exit your vehicle if you park in a standard accessible parking space (has a 5 foot wide access aisle)?

- Yes.
- No.

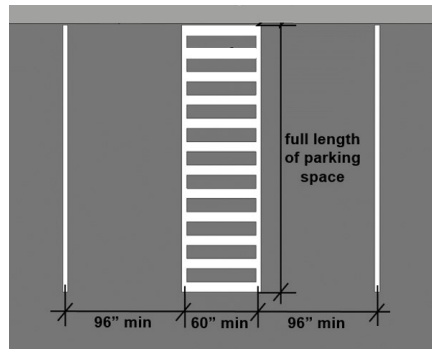

7. How often do you require extra space on both sides of your vehicle so both the driver and passenger(s) with disabilities are all able to safely exit the vehicles?

- Always
- Frequently
- Sometimes
- Rarely
- Never

8. Which of the following features of an accessible parking space do you require use of? (check all that apply)

- Parking space is located close to a facility entrance.
- Use of an access aisle.
- Use of a van accessible access space (8 foot wide access aisle or 11 foot wide space).

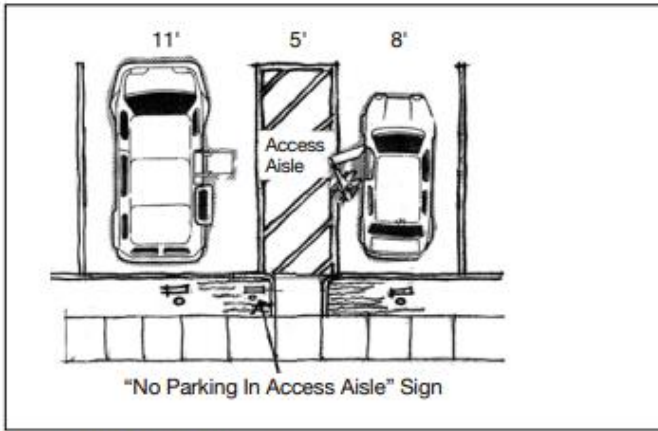

**Van-Accessible Space**

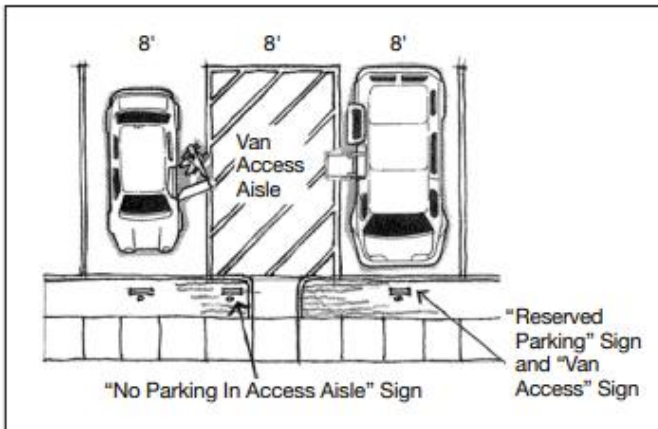

**Alternate Design Van-Accessible Space**

Other: \_\_\_\_\_

9. Please rate how often you are unable to park in an accessible parking space because the access aisle is not located on the side you or your passenger exits the vehicle from?

- Always
- Frequently
- Sometimes
- Rarely
- Never

10. Do you occasionally park partially in the access aisle because you are unable to reverse into the parking space and the access aisle is not located on the side you or your passenger exit the vehicle from?

Yes.

No.

11. How often do you have to park in two non-accessible parking spaces to create an access aisle because no accessible spaces are available?

Always

Frequently

Sometimes

Rarely

Never

12. Please rate how often you are unable to find an available accessible parking space at the locations below:

- Personal services such as banks or dry cleaners

Always

Frequently

Sometimes

Rarely

Never

- Food and beverage establishments

Always

Frequently

Sometimes

Rarely

Never

- Big box retail stores such as Costco

Always

Frequently

Sometimes

Rarely

Never

- Strip malls
  - Always
  - Frequently
  - Sometimes
  - Rarely
  - Never
  
- Shopping centers
  - Always
  - Frequently
  - Sometimes
  - Rarely
  - Never
  
- Educational facilities
  - Always
  - Frequently
  - Sometimes
  - Rarely
  - Never
  
- Sports Facilities
  - Always
  - Frequently
  - Sometimes
  - Rarely
  - Never
  
- Airports
  - Always
  - Frequently
  - Sometimes
  - Rarely
  - Never
  
- State/County recreational facilities (beach parks, gym, district parks, etc.)
  - Always
  - Frequently
  - Sometimes

Rarely

Never

• Other: \_\_\_\_\_

13. Which type of areas do you usually park or attempt to park in an accessible space? (check all that apply)

Personal services such as banks or dry cleaners

Food and beverage establishments

Big box retailers stores such as Costco

Strip malls

Shopping centers

Educational facilities

Sports Facilities

Airports

State/County recreational facilities (beach parks, gym, district parks, etc.)

Other: \_\_\_\_\_

14. Please rate the frequency of the following scenarios at locations you attempt to visit.

All accessible parking spaces are occupied by vehicles with valid disability parking permits.

Always

Frequently

Sometimes

Rarely

Never

All accessible parking spaces are occupied, some of which are by vehicles displaying expired or altered disability parking permits.

Always

Frequently

Sometimes

Rarely

Never

All accessible parking spaces are occupied, some of which are by vehicles displaying no disability parking permits.

- Always
- Frequently
- Sometimes
- Rarely
- Never

Automobiles (including motorcycles) are fully or partially parked in the access aisle.

- Always
- Frequently
- Sometimes
- Rarely
- Never

It is difficult for my vehicle to enter the accessible parking space due to the design of the parking lot (sharp angles, speed bump locations, etc.).

- Always
- Frequently
- Sometimes
- Rarely
- Never

The van accessible parking space is occupied, and I am only able to use van accessible spaces.

- Always
- Frequently
- Sometimes
- Rarely
- Never

There is an object blocking the parking space or access aisle (moped, shopping cart, sign pole, etc.).

- Always
- Frequently
- Sometimes
- Rarely
- Never

There are issues with the accessible route (slope, obstacles, potholes, etc.) that leads from the accessible parking space to the facility entrance.

- Always
- Frequently
- Sometimes
- Rarely
- Never

Other: \_\_\_\_\_

15. Which of these conditions have you noticed at the locations you visit? (check all that apply):

- Lack of signage on the accessible parking spaces.



- Lack of signage on the van accessible parking space access aisle.



- Lack of an access aisle.
- Visible slope in the accessible parking space.
- Visible slope in the access aisle.
- No curb cut and ramp near the accessible parking spaces.

Other: \_\_\_\_\_

16. Have you ever traveled off island and had to choose to use your placard to park in a reserved accessible space at your departure location (i.e. airport) or to take your placard with you for use at your destination?

- Yes.
- No.

17. Have you ever been unable to pay for parking in an off street parking lot due to a payment barrier?

- No, I can always make the payment.
- Yes, because they only accepted cash.
- Yes, because they only accepted credit or debit card.
- Yes, because payment was only accepted by QR code.
- Yes, because the equipment was unreachable.
- Yes, because I could not see or read the payment device instructions or display screen.

18. Additional Comments: \_\_\_\_\_

## 8. Parking

Accessible parking spaces are uniquely designed and located to accommodate the needs of qualified individuals with mobility impairments. A “person with a disability parking permit” (parking placard or special license plates) authorizes the use of accessible parking spaces. Placards include long term six (6) year placards, temporary placards, and Disabled Paid Parking Exemption Permits (DPPEP).

The goals and objectives in the area of **Parking** are:

- 8.1 Parking permits (placards or special license plates) will be issued to qualified individuals with mobility impairments in conformance with Chapter 291, Part III, Hawaii Revised Statutes and Hawaii Administrative Rules, Title 11, Chapter 219.

Objectives:

- 8.1.1 Procure placards, decals, identification cards and application forms for the parking program for persons with disabilities. **(Priority 1)**

**FY 27 Recommendation: No change.**

- 8.1.2 Continue Memorandums of Agreement (MOA) with the counties to issue all placards (except for renewals of six (6) year placards and issuance of all Disabled Paid Parking Exemption Permit placards), distribute supplies to the counties to fulfill the MOA, generate quarterly and annual statistics on issuance and distribute to the counties, and reimburse the counties per the MOA. **(Priority 1)**

**FY 27 Recommendation: No change.**

- 8.1.3 Administer in-house the statewide issuance of long term placard renewals by mail. **(Priority 1)**

**FY 27 Recommendation: No change.**

- 8.1.4 Continue Memorandum of Agreement with consultant to host the parking database and to add features, as needed, to improve the parking program (e.g., new section for permittees with a Disabled Paid Parking Exemption Permit). **(Priority 1)**

**FY 27 Recommendation: No change.**

- 8.1.5 Explore State legislation that would allow permittees who qualify for a Disabled Paid Parking Exemption Permit to receive the parking fee exemption through a special license plate. **(Priority 2)**

**FY 27 Recommendation: No change.**

8.1.6 Administer in-house the statewide issuance of the Disabled Paid Parking Exemption Permit by mail. **(Priority 1)**

FY 27 Recommendation: No change.

8.1.7 Establish a disability travel placard, including any necessary amendments to Chapter 291, Part III, Hawaii Revised Statutes and Hawaii Administrative Rules, Title 11, Chapter 219. **(Priority 2)**

FY 27 Recommendation: Change to Priority 1

8.2 Quality assurance measures will be established and maintained to ensure a viable and reliable parking program for persons with disabilities.

Objectives:

8.2.1 Retrieve voided or expired placards. **(Priority 1)**

FY 27 Recommendation: No change

8.2.2 Retrieve voided or expired placards upon death of permittee through death record matches, through family members or legal representatives and from county issuing agencies and provide information to law enforcement on invalid placards. **(Priority 2)**.

FY 27 Recommendation: Change to Priority 1

8.2.3 DCAB shall create and distribute a guidance document to Hawaii Licensed Medical Professionals regarding their role in the parking program.

FY 27 Recommendation: New objective.

8.3 Parking placards and parking spaces reserved for persons with disabilities will be enforced appropriately when abused. Misuse of placards and parking spaces reserved for persons with disabilities will be enforced appropriately.

Objectives:

8.3.1 Continue to support State and county agencies and enforcement personnel efforts to issue citations for illegal parking in accessible parking spaces consistent with the penalty amounts provided under Chapter 291, Part III. **(Priority 1)**

FY 27 Recommendation: No change

8.3.2 Develop and maintain methods for members of the public to report the use of an expired disability parking placard to obtain parking privileges or a vehicle parked in an access aisle while displaying a disability parking placard or special license plates. **(Priority 3)**

FY 27 Recommendation: No change

- 8.3.3 Staff will provide information to permittees on the proper use of disability parking permits and accessible parking spaces and access aisles when a report of improper use is received. **(Priority 3)**

FY 27 Recommendation: No change

- 8.3.4 Explore possibilities of a State or county agency enforcing accessible parking design requirements. **(Priority 1)**

FY 27 Recommendation: No change

- 8.3.5 Develop and maintain methods for members of the public to report locations with accessible parking spaces that are non-compliant with design regulations. **(Priority 3)**

FY 27 Recommendation: No change

- 8.3.6 Staff will provide information to parking lot owners on the federal and State design regulations when a report of a non-compliant accessible parking space is received. **(Priority 3)**

FY 27 Recommendation: No change

- 8.3.7 Explore possible legislation to reserve van accessible spaces for use by permittees who use a wheelchair or scooter and/or use a vehicle with a side mounted lift or ramp. **(Priority 3)**

FY 27 Recommendation: No change

- 8.3.8 Explore legislation to amend the meter fee exemption from “2.5 hours or the maximum time the meter allows” to “4 hours.” (Priority 3)

FY 27 Recommendation: No change

- 8.3.9 Explore a Memorandum of Agreement with the City and County of Honolulu to provide names and mailing address of registered vehicle owners upon request in response to reliable photographic evidence submitted to DCAB showing a vehicle parked in a reserved accessible space without displaying a valid parking permit. (Priority 2)

FY 27 Recommendation: New objective.

- 8.4 Public education and awareness activities will promote the appropriate use of parking spaces for persons with disabilities.

Objectives:

8.4.1 Provide technical assistance, training, and other public education efforts to consumers, operators of parking facilities, and the public on the requirements of the parking program. This includes supplying the Department of Education with flyers for its driver's education program, flyers to private driver education operators, and users guides to the permittees. **(Priority 1)**

**FY 27 Recommendation: No change**

8.4.2 Create and maintain a mechanism to communicate with permittees about pending permit expirations and the Disabled Paid Parking Exemption Permit issuance. **(Priority 1)**

**FY 27 Recommendation: No change**

8.4.3 Provide public education efforts aimed at consumers, operators of parking facilities, and the public on the importance of keeping van accessible spaces available for vehicles with side mounted lifts or ramps whenever possible. **(Priority 1)**

**FY 27 Recommendation: No change**

8.4.4 Work with the counties to mail warning letters to registered vehicle owners when reliable evidence is presented that the vehicle was parked in violation of HRS 291 Part III or HAR Chapter 219. (Priority 2)

**FY 27 Recommendation: No change**

8.5 Advocate that the Americans with Disabilities Act (ADA) Titles II and III entities provide accessible and van accessible parking spaces that exceed the minimum number required under the ADA Accessibility Guidelines. Advocate that all accessible parking spaces are maintained and located on an accessible route that connects to an accessible entrance.

Objectives:

8.5.1 Advocate for State and local governments to increase the number of accessible and van accessible parking spaces. **(Priority 2)**

**FY 27 Recommendation: No change**

8.5.2 Advocate for ADA Title III entities to increase their number of accessible and van accessible parking spaces, including the use of financial incentives such as tax credits. **(Priority 2)**

**FY 27 Recommendation: No change**

8.5.3 Testimony will encourage ADA Title II and Title III entities to provide van accessible parking spaces that exceed the minimum number required under the Americans with Disabilities Act Accessibility Guidelines. (**Priority 2**)

FY 27 Recommendation: No change

8.5.4 Explore possible legislation to require ADA Title II and III entities to provide additional accessible and/or van accessible parking spaces beyond ADA minimums. (Priority 1)

FY 27 Recommendation: New objective.

~~[8.5.4]~~ 8.5.5 Review and revise DCAB document entitled “How to Design an Accessible Parking Space.” (**Priority 2**)

FY 27 Recommendation: Renumber objective.

## [A Malpractice Case Against ParkingMD - New Mobility](#)

A new website promising to make getting disabled parking permits “fast & easy” threatens to destroy an already flawed system.

April 17, 2026

[Ian Ruder](#)



Writing or posting about disabled parking violations is like chumming the internet for outrage. As a power wheelchair user who depends on my side-entry rampvan, I get the outrage, but it bothers me that literally thousands of people will take the time to express their outrage about a post documenting some jerk's inconsiderate parking and only a few of those same readers will even take the time to read an article about how our healthcare system is being fundamentally dismantled by soulless bureaucrats who make the parking jerk look like a saint.

That said, when ads for [ParkingMD](#) started popping into my feeds, I had a feeling I was going to have to break my self-imposed writing ban. In one video short, an overly eager woman (possibly AI) celebrates how quickly she got her disabled parking placard thanks

to ParkingMD's online doctor assistance. She practically hyperventilates explaining how easy it is and how she doesn't have time for doctors or anything else.

Watching her shill for ParkingMD, I could feel my muscles tightening as I envisioned her pulling into the last disabled spot in front of me, hopping out of her vehicle and skipping to the store.

We are already facing a profound shortage of disabled parking that is exacerbated by the rampant abuse of the placard system by people with expired, fake and unneeded permits. If you don't believe me, check out the excellent work done by United Spinal's [working group on disabled parking](#). Who surveyed this landscape and came up with the brilliant idea of making it easier to take advantage of the system and create even greater gridlock?

I finally got around to investigating when another ParkingMD ad popped up in my timeline. Instead of AI, this one had a photo of a friend of mine, sitting outside a truck in the snow in his wheelchair. I felt pretty confident no actual wheelchair user — much less one I knew and respected — would support ParkingMD, so I reached out. He told me he had never heard of ParkingMD (the photo was a stock photo the company had licensed) and was just as triggered as I was when he found out what they do on their [website](#).

ParkingMD claims that in their first year they've already helped over 33,000 people get their placards online via their network of doctors who review disabled claims and submit the necessary paperwork.

In our system, having a doctor verify your disability when applying for a placard is the last finger in the dyke. Moving these evaluations online with rent-a-docs who have no history with the applicants and no tangible way to verify their claims is like chopping that finger off and sticking in dynamite to blow the whole dyke up.

### Help Solve Our Broken Accessible Parking System

Join United Spinal Association's Accessible Parking Working Group to advocate for improved accessible parking laws and regulations and increase awareness and education regarding common barriers encountered by wheelchair users.

ParkingMD is basically issuing placards on the honor system. Forgive me for doubting that has a chance in hell of working, but I've seen how unscrupulous people take advantage of the pre-existing flaws in disabled parking. Now ParkingMD is opening up the biggest loophole yet and all but directing traffic into those already-contested disabled spots.

Despite ParkingMD's altruistic claims, the only reason to do this is obvious: money. All that stood between them and collecting thousands of application fees needed was a set of online doctors and a program to connect placard-seekers and online docs.

To find out who was willing to blow up the disabled parking system for a quick buck, I reached out to ParkingMD via the phone number and support email listed on the website. Unsurprisingly, no one got back to me.

Now even more motivated, I dove headfirst into an afternoon of ChatGPT sleuthing, LinkedIn snooping and general internet surfing. Long story short, I eventually discovered a work tie between a Pakistani engineer and a Chicago area company that helped me find the LinkedIn profile of a woman who was listed as the contact on the lone ParkingMD press release I could track down.

What do you do if you've got a list of signature-happy doctors and a proven online platform ready to go? You find a new thing that needs doctor approval: Hello ParkingMD.

According to her LinkedIn profile, she worked for the Leafy Group, a company "attacking cannabis with tech from innovative new angles." Under older posts I found the smoking gun that made everything make sense – a job posting looking for "Remote Physicians Telemed Medical Marijuana Evaluations."

During the pandemic many states temporarily legalized telehealth for medical marijuana evaluations so patients could maintain access during the lockdown. As telehealth visits surged from 11% of patients in 2019 to around 46% in 2021, a market emerged for finding online doctors and connecting them with patients.

Four years later, I'm guessing that market isn't quite so hot. What do you do if you've got a list of signature-happy doctors and a proven online platform ready to go? You find a new thing that needs doctor approval: Hello, disabled parking placards. Hello ParkingMD.

Between placard abuse, parking spot shortages and [multiple states debating legislation to open up disabled parking to pregnant women](#), it's hard not to feel like the system is on verge of collapsing. ParkingMD feels like a shortsighted money grab that could have a devastating long-term effect.

Based on their tone-deaf ads and callous business model, I'm confident the executives behind ParkingMD don't give a shit about what the disability community thinks, but that shouldn't stop any of us from giving them hell. I'm guessing that ParkingMD is fully aware of how shady their company is and wants nothing to do with thousands of outraged wheelchair users. Take a minute to let them know how you feel about their *brilliant* plan to make getting a placard "fast & easy" by [emailing](#), calling (786-744-4303) or commenting on their social media ads.

And if you have any doubt about ParkingMD's intentions, or you are worried that maybe they are just misguided, I'll leave you with this...



Parkingmd

Sponsored · 🌐



Tired of walking miles across the parking lot? Getting your handicap parking permit doesn't have to be a slow, frustrating process. With ParkingMD, you can complete you... See more

## Facebook /Instagram Ad Design



# STOP WALKING MILES TO THE DOOR

Get Your Parking Permit  
Online – Fast & Easy



PARKINGMD.COM

Get Your Parking Permit 100% Online 📄

Fast, easy, and doctor-approved. Apply in minutes.

Learn more

6:48



Sarah Miles  
To: Bryan Mick >  
Reply To: support@parkingmd.com >

Hi Bryan, you're almost there!



Hi Bryan,

It's Sarah from ParkingMD. You're almost there!

**The DMV will NOT issue your placard without a doctor-signed medical form.**

That's *exactly* what we provide — fully completed, state-specific paperwork signed by a licensed physician. The whole process is simple and our doctors are available 7 days a week.

Here's how it works:

- Complete your payment
- Pick an appointment time that works for you
- Quick 2-3 minute video call with a licensed physician
- Paperwork ready in 1-2 days
- Download instantly or mailed to you (by state)

Use code **PARK20** for \$20 off.

**Complete My Application —  
Save \$20**

     
[support@parkingmd.com](mailto:support@parkingmd.com) — happy to help!



**Disability Parking Permit System**  
 Disability and Communication Access Board  
 Department of Health • State of Hawaii



**PARKING DATA ANALYSIS**  
**04/09/2026**

**7810 Total # of Placards Issued**

**By Station (31)**

00 DCAB: 2518	15 Hawaii Kai: 347
01 Administration: 105	20 Kahului: 344
02 Ala Moana: 512	21 Kihei: 83
03 Chinatown 114	22 Lahaina: 80
04: 0	23 Pukalani: 89
05: 0	24 Hana: 10
06 Kapalama Hale: 374	25 Molokai: 35
07 Kapolei: 601	26 Lanai: 12
08: 0	30 Lihue: 232
09 Pearlridge: 575	31 Kapaa: 18
0A: 0	40 Hilo: 932
10 Wahiawa: 282	41 Kona: 1
11 Waianae: 137	50: 0
12 Windward City: 409	60: 0
13: 0	XX DCAB GK: 0
14: 0	

**By County and DCAB**

Honolulu: 3456	Kauai: 250	Maui: 653	Hawaii: 933
DCAB: 2518			

**5732 Permanent Placards by County and DCAB**

Honolulu: 2048	Kauai: 170	Maui: 388	Hawaii: 629
DCAB: 2497			

**2056 Temporary Placards by County and DCAB**

Honolulu: 1408	Kauai: 80	Maui: 264	Hawaii: 304
DCAB: 0			

**402 License Plates Issued**

Honolulu: 108	Kauai: 10	Maui: 32	Hawaii: 51
DCAB: 201			

**3589 First Time Placards by County and DCAB**

Honolulu: 2383	Kauai: 165	Maui: 441	Hawaii: 600
DCAB: 0			

**2294 First Time Long Term Placards by County and DCAB**

Honolulu: 1493	Kauai: 114	Maui: 259	Hawaii: 428
DCAB: 0			

**3296 Renewal** Placards by County and DCAB

Honolulu: 553                      Kauai: 37                      Maui: 80                      Hawaii: 134  
DCAB: 2492

**915 Replacement** Placards by County and DCAB

Honolulu: 518                      Kauai: 48                      Maui: 132                      Hawaii: 199  
DCAB: 18

**148 Mutilated** Placards by County and DCAB

Honolulu: 75                      Kauai: 3                      Maui: 23                      Hawaii: 47  
DCAB: 0

**8 First Hawaii DPPEP** Placards by County and DCAB

Honolulu: 0                      Kauai: 0                      Maui: 0                      Hawaii: 0  
DCAB: 8

**2 Renewal of Hawaii DPPEP** Placards by County and DCAB

Honolulu: 2                      Kauai: 0                      Maui: 0                      Hawaii: 0  
DCAB: 0

**0 Replacement of Hawaii DPPEP** Placards by County and DCAB

Honolulu: 0                      Kauai: 0                      Maui: 0                      Hawaii: 0  
DCAB: 0

**0 Replacement of Mutilated Hawaii DPPEP** Placards by County and DCAB

Honolulu: 0                      Kauai: 0                      Maui: 0                      Hawaii: 0  
DCAB: 0

**\$32,892.00 Total Amount of Money Collected** by County and DCAB

Honolulu: \$21,858.00    Kauai: \$1,488.00    Maui: \$4,332.00    Hawaii: \$5,184.00  
DCAB: \$30.00

**\$29,304.00 Calculated Amount for Counties to Invoice**

Honolulu: (1568) x \$12.00 = \$18,816.00                      Kauai: (117) x \$12.00 = \$1,404.00  
Maui: (282) x \$12.00 = \$3,384.00                      Hawaii: (475) x \$12.00 = \$5,700.00

# PARKING UNIT REPORT

May 21, 2026

## Parking Program Issuance and Statistics – Update

In the third quarter of FY 2025-2026, around 7,800 placards were issued and 400 special license plates reauthorized or issued. Of the placards, about 2,100 were temporary, 5,700 long term, and 10 were Disabled Paid Parking Exemption Permits. Of the long-term placards, about 2,500 were renewals issued by DCAB. The renewal rate was 65 percent.

## Other Parking Activities from the Plan of Action

In the third quarter of the Fiscal Year:

2,457 emails were sent reminding permittees of a pending permit expiration.

Year and month decals were received. Procurement is ongoing for placards.

A crosscheck with Vital Record flagged 3,400 records. As of 5/06/26, 46% were returned, 5% were reported as lost, and 12% of the letters were undeliverable.

9 submissions were received via the webpage to report parking placard misuse. For one, DCAB was able to verify an out of state placard being used was valid, and for a second one follow up was done with the permittee.

1 submission was received via the webpage to report a non-design complaint space.

Staff attended a zoom meeting of the United Spinal Association Working Group on Accessible Parking.

April (Year to Year)

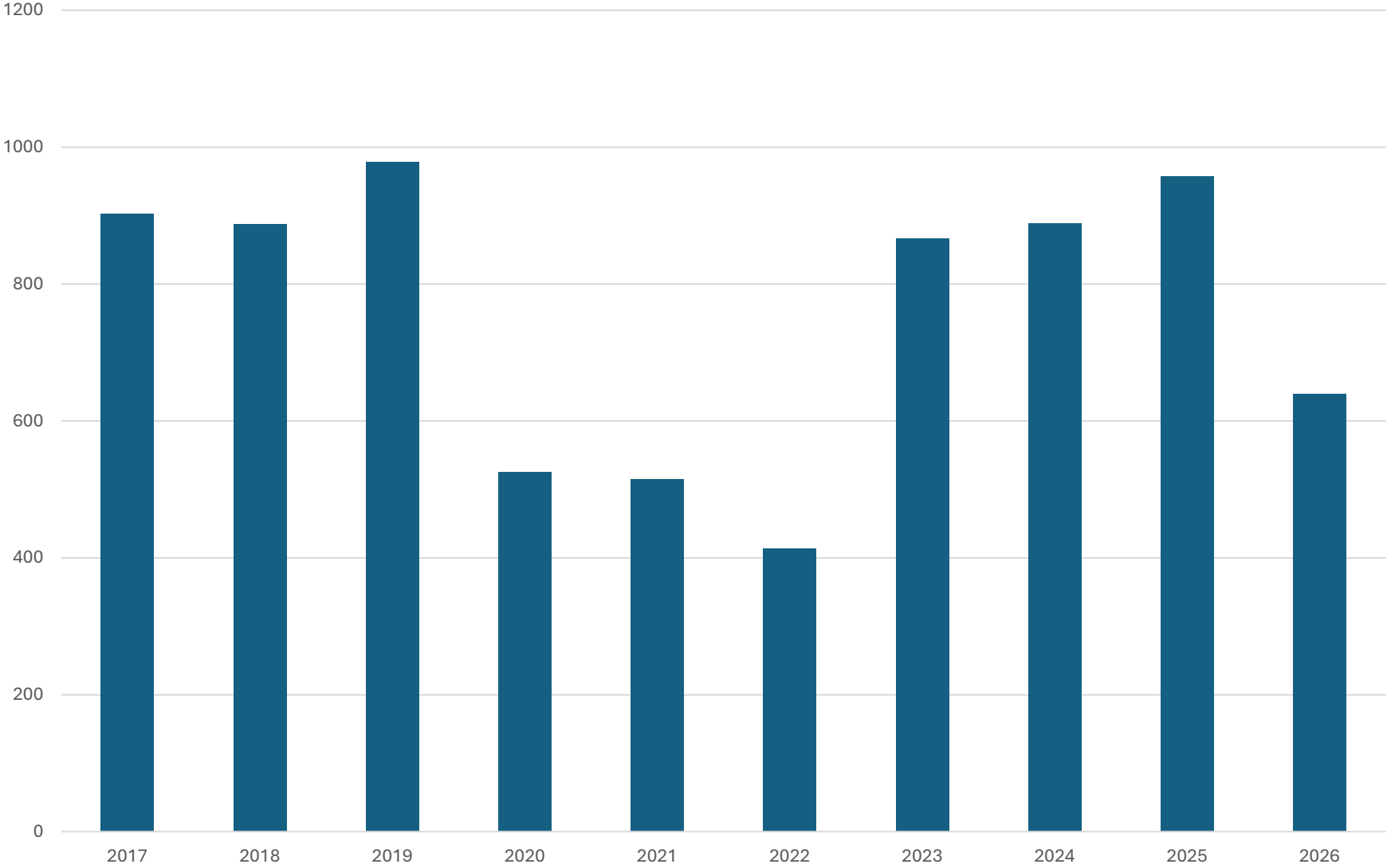

■ Renewal Long Term

## Disability License Plates

While a parking placard can move from vehicle to vehicle with the disabled person, disability plates must be permanently affixed to the vehicle for which they are issued. Disability plates are issued only to persons with permanent disabilities who own a vehicle and have their name on the vehicle title; a parent or legal guardian of a minor with a disability; or an immediate family member who owns the vehicle, resides in the same household as the person with disabilities and is responsible for transporting them. Disability license plates allow the authorized holder to park in spaces reserved for persons with disabilities, such as at malls, grocery stores, etc., and **DO NOT** exempt the authorized holder from parking meter fees and time limitations at parking meters unless the authorized holder displays the Meter-Exempt Parking Placard.



- **Disabled Veteran Plates** are issued only to veterans who provide proof of a service-connected disability that is certified by a licensed physician. Disabled Veteran Plates allow the authorized holder to park in spaces reserved for persons with disabilities, such as at malls, grocery or retail stores. The same parking limitations and parking restrictions apply as for regular disability plates.



## Penalties for Misuse

- The minimum fine for parking in a space reserved for persons with disabilities without disability license plates or a parking placard is \$250. Local municipalities may increase the fine up to \$350.
- Unauthorized use of disability plates or parking placards can result in a \$600 fine and driver's license suspension for a first offense.
- Police officers may confiscate a placard, and the Secretary of State's office may suspend or revoke license plates or parking placards being used illegally.

The following are Class A misdemeanors for a first offense and may result in a fine of up to \$2,500 and a one-year driver's license suspension. Violators may be charged with a Class 4 felony for a second offense.

- Using a deceased person's disability license plates or parking placard.
- Altering a parking placard.
- Possessing a fake, fraudulent, lost or stolen parking placard.
- Duplicating or manufacturing a parking placard.
- Selling or otherwise distributing a fraudulent parking placard.

**The fraudulent use of disability license plates and parking placards is a serious problem.**

**Medical professionals are part of the solution!**

For more information or to obtain an application for the Parking Program for Persons with Disabilities:

Office of the Secretary of State  
Persons with Disabilities  
License Plates/Placard Unit  
501 S. Second St., Rm. 541  
Springfield, IL 62756  
217-782-2709  
800-252-8980  
888-261-5280 (TTY)

[WWW.CYBERDRIVEILLINOIS.COM](http://WWW.CYBERDRIVEILLINOIS.COM)

JESSE WHITE  
SECRETARY OF STATE

## A Guide for Medical Professionals

## Parking Program for Persons with Disabilities



JESSE WHITE  
SECRETARY OF STATE



The fraudulent use of disability license plates and parking placards is a matter I take very seriously. Medical professionals play an integral role

in preventing the abuse of parking privileges for persons with disabilities by ensuring that a patient is qualified before approving him or her for disability plates or a parking placard.

My office has developed an electronic application to help medical professionals more easily submit a patient's parking placard application.

The Parking Program for Persons with Disabilities is vital to many Illinois residents with disabilities to help them maintain their independence and stay active. By working with medical professionals, disability organizations and law enforcement, we can ensure that those who qualify for special parking privileges have the access they deserve.

*Jesse White*

Jesse White  
Illinois Secretary of State

# A GUIDE FOR MEDICAL PROFESSIONALS

## PARKING PROGRAM FOR PERSONS WITH DISABILITIES

### Application/Certification Process

In order to obtain a parking placard or disability license plates, a licensed physician must complete Parts 2 and 3 of the Persons with Disabilities Certification for Parking Placard/License Plates. This process can now be done electronically or by using the paper system. Visit [www.cyberdriveillinois.com](http://www.cyberdriveillinois.com) and select the Disability Parking Certification link to access the electronic application.

The physician must:

- State the patient's medical diagnosis.
- Check the appropriate qualifying medical conditions.
- Specify the appropriate length of the disability — either permanent, permanent meter-exempt or temporary. If temporary, the physician must state the duration of the disability, which may not be more than six months.
- Sign and date the application where required and include the physician's license number. Copies or stamps of a physician signature are not accepted.
- Include the physician's name, address and telephone number.

Certification forms are available at Secretary of State facilities, at [www.cyberdriveillinois.com](http://www.cyberdriveillinois.com), or by contacting: Secretary of State, Persons with Disabilities License Plates/Placard Unit, 501 S. Second St., Rm. 541, Springfield, IL 62756; 800-252-8980.

Physicians who knowingly misuse the application process or who make false statements to help someone obtain disability plates or a parking placard may be fined up to \$1,000.

### Program Eligibility

In order to obtain a parking placard or disability license plates, a licensed physician, physician assistant or advanced practice nurse must certify that a person meets at least one of the qualifying medical conditions. Please keep in mind, a person with an impairment is **not** automatically eligible for disability plates or a parking placard.

When considering a patient's eligibility for the program, a licensed physician must certify that the applicant has **one** of six specific medical conditions that severely impairs his or her ability to walk.

### Types of Parking Placards

The Secretary of State's office issues four types of parking placards:

**1. Meter-Exempt Permanent Placards** are issued to persons with permanent disabilities who have significant impairments that cause difficulty in accessing a parking meter. The Meter-Exempt Permanent Placard

allows the authorized holder to park in spaces reserved for persons with disabilities, such as at malls, grocery stores, etc., and the placard exempts the authorized holder from payment of parking meter fees and time limitations. In order to be eligible for this placard, the person with the disability must possess a valid Illinois driver's license, and their physician must certify they meet at least **one** additional qualifying medical condition listed on the application.

**2. Permanent Placards** are issued to persons with permanent disabilities, and allow the authorized holder to park in spaces reserved for persons with disabilities, such as at malls, grocery stores, etc. This placard **DOES NOT** exempt the authorized holder from parking meter fees and time limitations at parking meters.

**3. Temporary Placards** are issued to persons with a temporary disability and are valid for the length of time indicated by the certifying physician, not to exceed six months if issued by the Secretary of State. The Temporary Placard allows the authorized holder to park in spaces reserved for persons with disabilities, such as at malls, grocery stores, etc., and **DOES NOT** exempt the authorized holder from parking meter fees and time limitations at parking meters.

**4. Organization Placards** are issued to organizations that transport persons with disabilities free of charge and expire on April 30, 2018. No physician signature is required for an Organization Placard. The Organization Placard allows the authorized agent to park in spaces reserved for persons with disabilities when transporting persons with disabilities and **DOES NOT** exempt the authorized agent from parking meter fees and time limitations at parking meters.



# Van Accessible Parking



*Graphic courtesy of ADA.*

## The Purpose of Van Accessible Parking

Van Accessible Parking allows room for people to load or unload a wheelchair, scooter, walker or similar device that is used to transport a person who has limited or no use of his or her legs.

Van Accessible Parking locations have an extra three feet of width compared to regular accessible parking spaces. This additional area gives the user room to deploy his or her ramp and/or safely remove and replace the equipment needed to transport the person.



*Photo Courtesy of Research and Training Center on Independent Living-The University of Kansas.*

If this area is blocked even a small amount, a person with a disability who requires the extra room may not be able to get out of or into his or her vehicle.

Numerous parking lots have only one or limited Van Accessible Parking locations available. This legislation ensures this parking space is utilized by those using a mobility device that needs the extra room to enter and exit the vehicle safely.

## The Van Accessible Parking Act Arkansas Act 799

Enforcement of Act 799 went into effect January 1, 2019, to regulate Van Accessible Parking penalties. This bill defines authorized parking use of a Van Accessible Parking space via a Van Accessible Parking decal.



Van Accessible Parking spaces are indicated by the Van Accessible signs.

Act 799 also specifically defines that the vehicle authorized to park in the Van Accessible Parking space must be used to transport a person with limited or no use of his or her legs and uses a wheelchair, a three or four-wheeled scooter, a four-wheeled walker with a seat or similar device.

If convicted, the owner of the vehicle is subject to a fine of \$250-\$500 for the first offense, and \$500-\$1,000 for the second and subsequent offenses. The fine for a first offense shall be reduced to \$100 upon successful completion of a class designed by the Office of Motor Vehicles to promote awareness of the need for compliance with parking and related public accommodation requirements.

## The Van Accessible Parking Act Arkansas Act 799

The Van Accessible decal is an addition to an existing license plate or hang-tag for those with a qualifying disability who use a mobility device.

Those individuals who need a Van Accessible Parking decal must visit his or her local State Revenue Office to obtain the mandatory disability form. This required form must be taken to the individual's healthcare provider to validate he or she medically qualifies to secure the Van Accessible Parking decal. After receiving the proper documentation, State Revenue Offices will provide these Van Accessible Parking decals which affix to the left side window of his or her license plate.

The Van Accessible Parking Act states a vehicle displaying a Van Accessible Parking decal, a special license plate, a special certificate or a temporary special certificate and being used for the actual transporting of a person with a disability is permitted exclusive parking privileges in those areas designated for parking only by persons with the Van Accessible Parking decal, special license plate, or special certificate.



## Three Feet Wider

Van Accessible Parking locations are three feet wider than regular accessible parking spaces for a total of 16 feet. Depending on the parking lot owner's choice, this extra three feet can either be in the parking space itself or the access aisle (the striped area beside the accessible parking space).

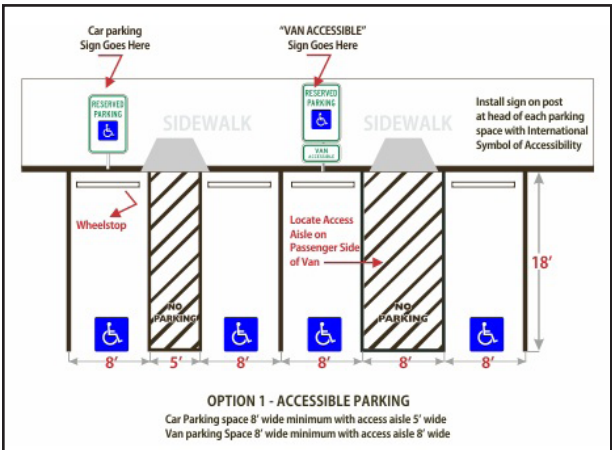

The graphic above (Option 1) shows the extra three feet for the Van Accessible Parking in the access aisle beside the parking space.

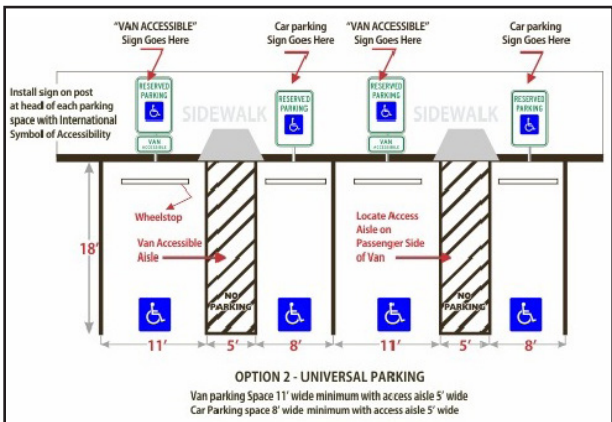

The graphic above (Option 2) shows the extra three feet for the Van Accessible Parking in the parking space itself.

## It's the Law!

All violators abusing the disability rights of Van Accessible Parking spaces are subject to a fine as governed under Arkansas Law: Codes 27-15-305, 27-15-306 & 14-54-501. Law enforcement officers have clear authority to enforce the provisions of Act 799 on private and public property, such as at a mall, retailer, grocery store, private agency in the state and other public venues.

Parking is not allowed in an access aisle (the striped area used for van access) of a parking space. Officers may ticket any vehicle parked in the van access aisle whether or not it is displaying disability plates or a placard.

---

This brochure is provided by the Arkansas Governor's Commission on People with Disabilities to promote awareness of the need for compliance with parking and related public accommodation requirements.



**Arkansas Governor's Commission  
on People with Disabilities**

525 W. Capitol Ave.  
Little Rock, AR 72201  
501-296-1637  
501-296-1883 (Fax)